

INSET DOOR PIVOT HINGE



PP



Left handed model shown.

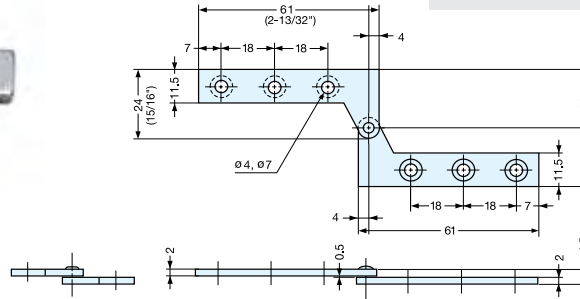

Right handed model shown.

- Door Size: Max. W450 x H700 mm (W17-3/4" x H27-9/16")
- Door weight: Max. 2.6 kg/pair (5.7 lbs/pair)

Item No.		Weight (g)	Box (pcs)	Carton (pcs)	Material	Finish
Left	Right					
PP-L	PP-R	22	100	1000	430 Stainless Steel	Plain

INSET DOOR PIVOT HINGE



PH



Left handed model shown.

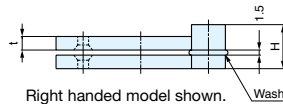
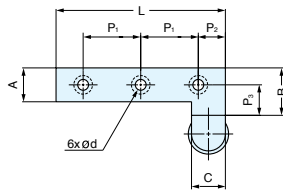

Right handed model shown.

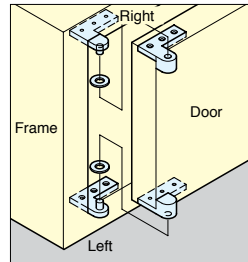

Installation

- Door Size: Max. W450 x H700 mm (W17-3/4" x H27-9/16")
- Recommended Door Thickness:
 - PH-50 : Min. 14 mm (9/16")
 - PH-60 : Min. 16 mm (10/16")
 - PH-80 : Min. 20 mm (3/4")
 - PH-95 : Min. 28 mm (1-1/8")
- Door weight:
 - PH-50, 60: Max. 2.6 kg/pair (5.7 lbs/pair)
 - PH-80, 95: Max. 4 kg/pair (8.8 lbs/pair)

Material	Finish
Brass	Satin Nickel

Item No.	L	t	H	A	B	C	P ₁	P ₂	P ₃	d	Door Thickness (mm)	Weight (g)	Box (pcs)	Carton (pcs)	Screws
PH-50	50	4	13	10	14	10	17	8	9	3.2	14 (35/64")	40	10	20	3.1 x 20
PH-60	60	4.5		12	16	12	21	9			16 (5/8")				
PH-80	80	6	22	16	20	15	30	10	12	4.2	20 (25/32")	170	8	32	3.8 x 25
PH-95	95	6.5		19	28	16	35	12.5			18.5				

INSET DOOR PIVOT HINGE



PAW



Left handed model shown.

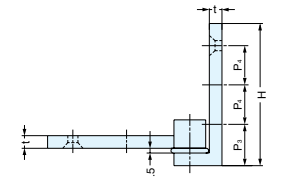
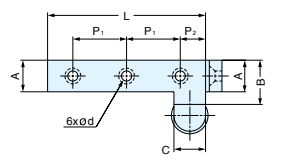

Right handed model shown.

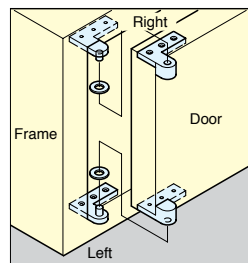

Installation

- Door Size: Max. W450 x H700 mm (W17-3/4" x H27-9/16")
- Recommended Door Thickness:
 - PAW-50 : 14 mm (9/16")
 - PAW-60 : 16 mm (10/16")
 - PAW-80 : 20 mm (3/4")
 - PAW-95 : 28 mm (1-1/8")
- Door weight:
 - PAW-50, 60: Max. 2.6 kg/pair (5.7 lbs/pair)
 - PAW-80, 95: Max. 4 kg/pair (8.8 lbs/pair)

Material	Finish
Brass	Satin Nickel

Item No.	L	t	H	A	B	C	P ₁	P ₂	P ₃	P ₄	d	Door Thickness (mm)	Weight (g)	Box (set)	Craton (set)	Screws
PAW-50	50	4	45	10	14	10	17	8	13	12.5	3.2	14 (35/64")	43	10	200	3.1 x 20
PAW-60	60	4.5	50	12	16	12	21	9	12.5	15.5		16 (5/8")				
PAW-80	80	6	70	16	20	15	30	10	15	23	4.2	20 (25/32")	172	8	32	3.8 x 25
PAW-95	95	6.5	80	19	28	16	35	12.5	18	25.5		28 (1-3/32")				