

ATACAMA

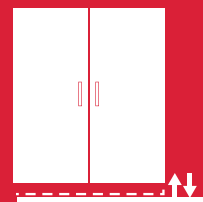

LEVELLERS

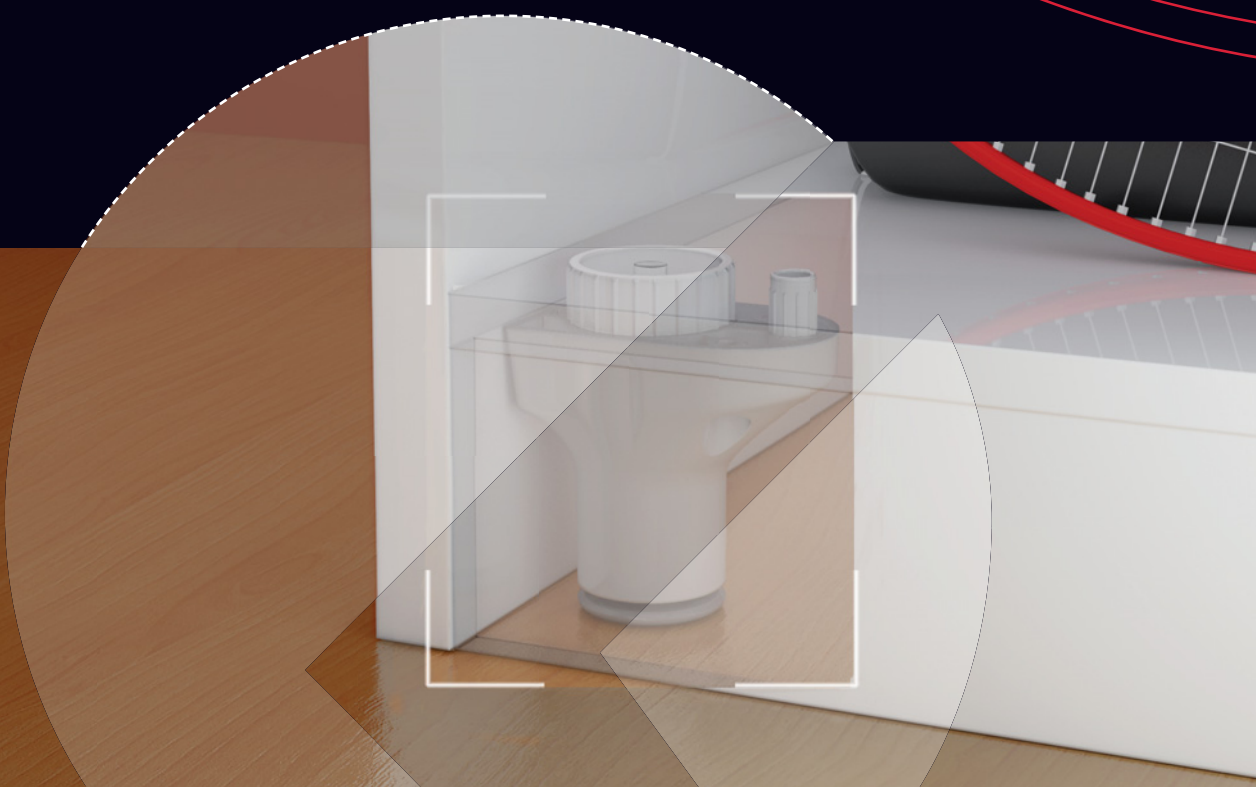



SYMBOLS AND FINISHES LEGEND

SYMBOLS

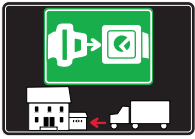

= SHELF SAFELY LOCKED DURING TRANSPORTATION AND AT HOME.



= ANTI-TURNOVER LOCKING SYSTEM



= NORMS / PATENTS



= PHILLIPS / POZIDRIV



= NEWTON



= PART.NO



= HEXAGONAL SOCKET



= FRICTION



= PCS. PER PACKAGE



= BLADE SLOT



= AUTOMATIC



= COMBI SLOT



= DROP DOWN



= CAPACITY LOADING



= COUNTERSUNK HEAD



= WOOD / GLASS THICKNESS



= PAN HEAD



= STANDARD HINGE



= HOLE DIAMETER



= FLANGE HEAD



= KIMANA HINGE



= DIAMETER



= FLAT HEAD



= FLAP HINGE



= LENGTH



= TRILOBULAR SCREW



= WITH SPRING



= HEIGHT



= SELF-TAPPING SCREW



= WITHOUT SPRING



= RIGHT VERSION



= EURO THREAD



= REVERSED SPRING



= LEFT VERSION



= METRIC THREAD



= PRE-INSERTED SCREW



= FOR ROUND TUBE



= PCS. PER PAD



= PRE-INSERTED SCREW AND SPREADING BUSH



= FOR OVAL TUBE



= CUT ON REQUEST



= WITH BUFFER



= SELF ADHESIVE



= WITH MAGNET



= WITH FLANGE

MATERIALS

ZA = Zinc Alloy	ST = Steel	HSS = High Speed Steel	BR = Brass	ABS = Acrylonitrile Butadiene Styrene
ZAnk = Nickel-plated Zinc Alloy	STzk = Zinc-plated Steel	AL = Aluminium	WD = Wood	EVA = Ethylene Vinyl Acetate

EP = **ENGINEERING PLASTIC**

+ **EP** = other engineering plastic available on request

SR = **SOFT RUBBER**

+ **SR** = other soft rubber available on request

EPn = Natural Engineering Plastic	EPc = Clear Engineering Plastic	SRn = Natural Soft Rubber
EPw = White Engineering Plastic	EPg = Grey Engineering Plastic	SRw = White Soft Rubber
EPwg = Water Green Engineering Plastic		SRb = Black Soft Rubber

FINISHES

+  = OTHER FINISHES AVAILABLE ON REQUEST

PART. NO	FINISHES	PART. NO	FINISHES	PART. NO	FINISHES
AA	Natural	JB	Bright Aluminium	PZ	Beech
AB	White	JC	Aluminium - Chrome	QA	Maple
AC	Opal White	JD	Matt Aluminium	QB	Walnut
AE	White 9010	JE	Satin-finished Aluminium	WA	Bronzed
AK	Champagne	JF	Aluminium - Brass	WI	Burnished
AL	Ivory	JG	Aluminium 5	XD	Satin-finished Steel
EA	Black	JL	Aluminium PE 11	YA	Nickel-plated
EB	Glossy Black	JM	Aluminium RAL 9006	YB	Bright Nickel-plated
EC	Matt Black	KA	Chrome	YC	Matt Nickel-plated
GR	Raw	KB	Bright Chrome	YD	Satin-finished Nickel-plated
HA	Brass-Plated	KC	Matt Chrome	ZA	Zinc alloy
HH	Tropicalized	MA	Brown	ZN	Zinc-plated
HL	Raw Brass	MB	Light Brown 1	ZQ	Bright Gold
IA	Grey	NN	Metallic Beige	ZY	Titanium
IB	Metallic Grey	NO	Beige	ZZ	Clear
IF	Middle Grey	OA	Oak	00	Insignificant finish
IJ	Light Grey	OZ	Ash		
IL	Grey 20	PA	Light Ash		
JA	Aluminium	PY	Cherry		



ATACAMA

ATACAMA is the new leveller to align heavy duty wardrobes, bookcases and modular furniture.

Suitable for 60mm plinths.

It is fixed on the furniture bottom through two housings, in order to provide an easier and more stable installation.

A lateral pin slots into the furniture side to achieve a structural connection, as well as an equal load distribution over the furniture side and base.

Finally, two screws secure ATACAMA to the furniture bottom.

A \varnothing 8mm through hole in the furniture bottom allows to adjust the leveller from above, by using a S6mm allen wrench or a 1x5.5mm blade screwdriver.

Capable of supporting a 175kg load each.

25mm adjustment

175 Kg per piece



Tested in accordance with CATAS procedures

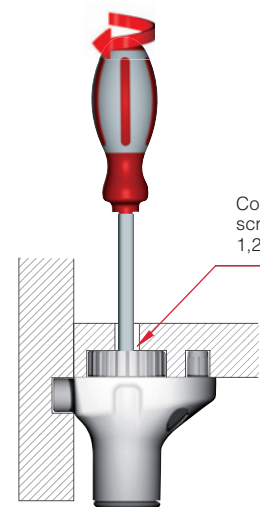
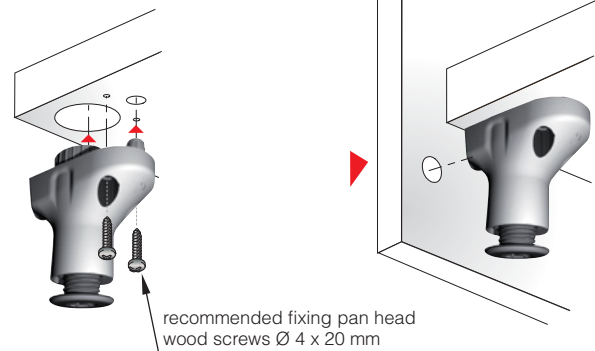
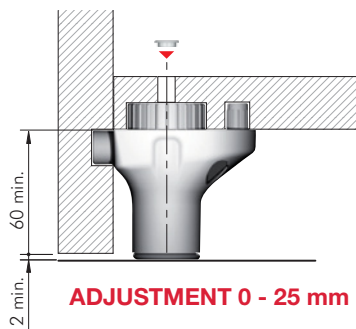

Combi slot for S6mm allen wrench or blade screwdriver 1x5,5 mm (LOWER CAVITY) or 1,2x8 mm (UPPER CAVITY).

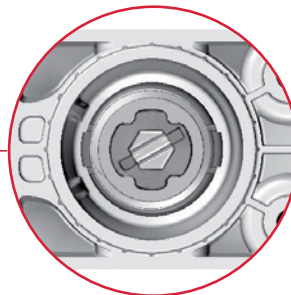

VERY IMPORTANT:

1) Both the screwdriver as well as the allen wrench must be fully inserted in the cavities, in order to avoid damaging of the engineering plastic sockets.

2) Loading capacity = 175Kg each.

However, notice that with furniture already loaded:

- Adjustment capacity through S6 mm allen wrench \leq 175Kg.
- Adjustment capacity through 1x5,5 mm blade screwdriver (LOWER SLOT) \leq 63Kg.
- Adjustment capacity through 1,2x8 mm blade screwdriver (HIGHER SLOT) \leq 63Kg.

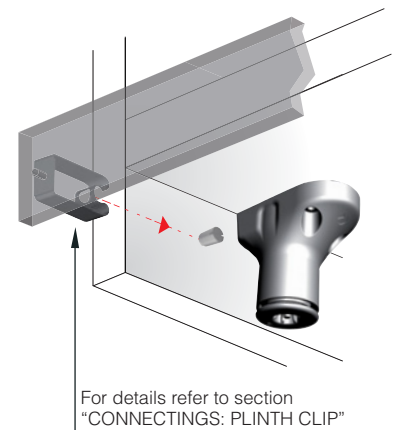

For details refer to section "CONNECTINGS: PLINTH CLIP"

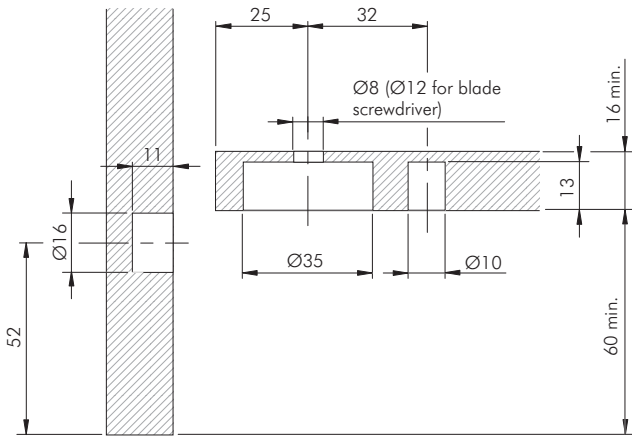

= S6 mm	= 1x5,5 mm (LOWER SLOT) 1,2x8 mm (HIGHER SLOT)
EP	= 70 pcs.
123	
31601000J	

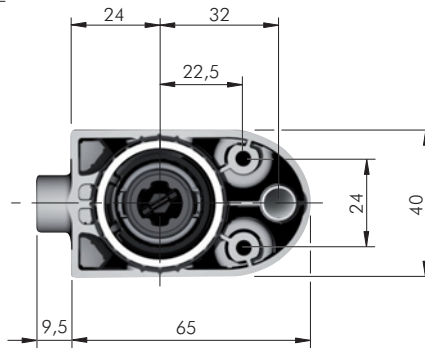
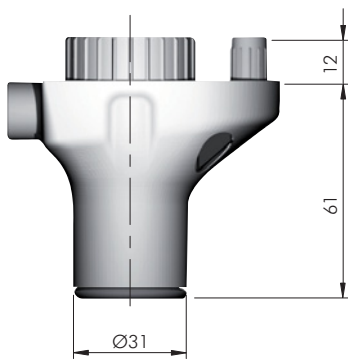

ATACAMA ACCESSORY

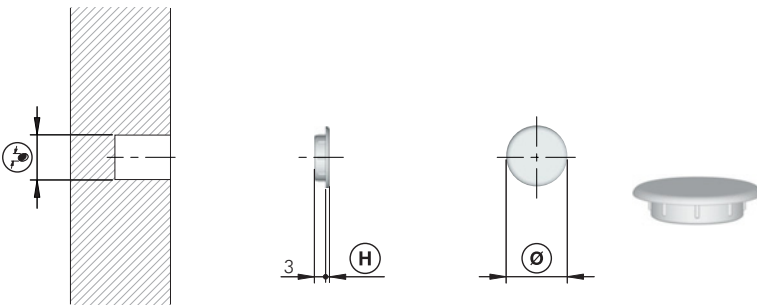

= Ø 8, Ø 12 mm					
EP					
123					
23002010AB	Ø 8	Ø 11	1	5000	
23002030AB	Ø 12	Ø 15	1	5000	

ATACAMA FIXING ACCESSORY

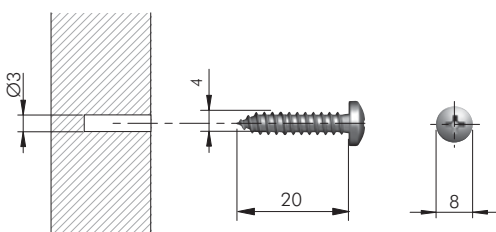

ST	= 500 pcs.
123	
60103270ZN	



PLINTH CLIP FOR ATACAMA

- For details refer to section "CONNECTINGS: PLINTH CLIP"

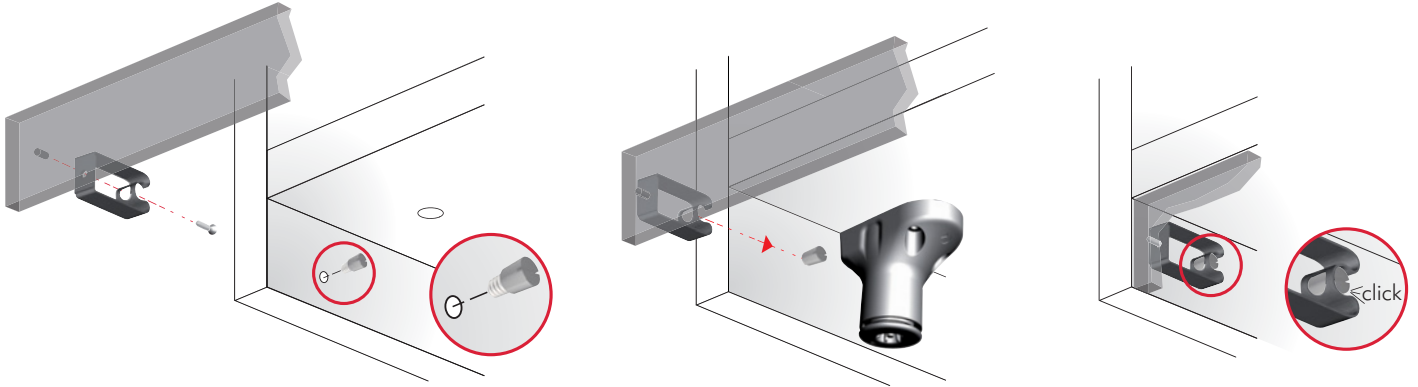

DRILL BIT FOR ATACAMA

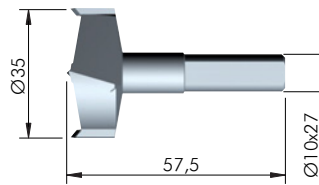
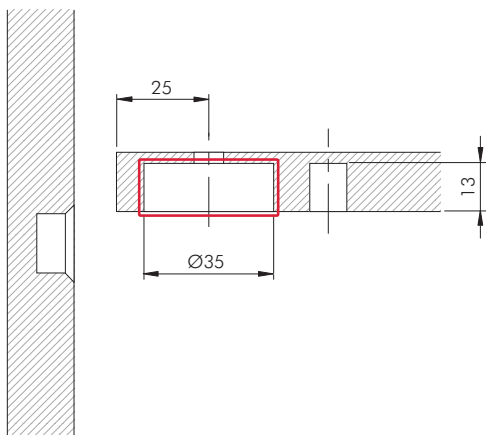

HSS	= on request
3175201000	

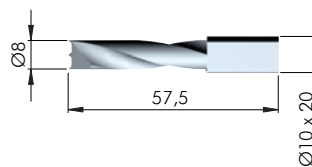
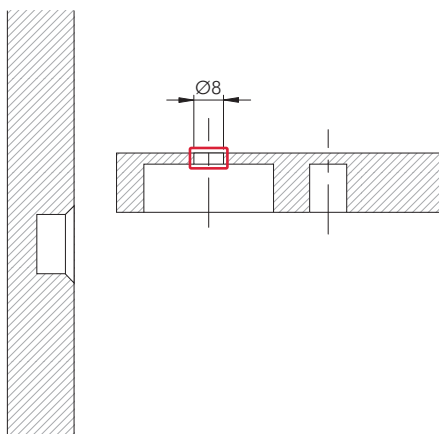

HSS	= on request
1145202000	

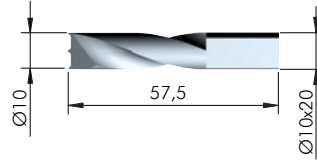
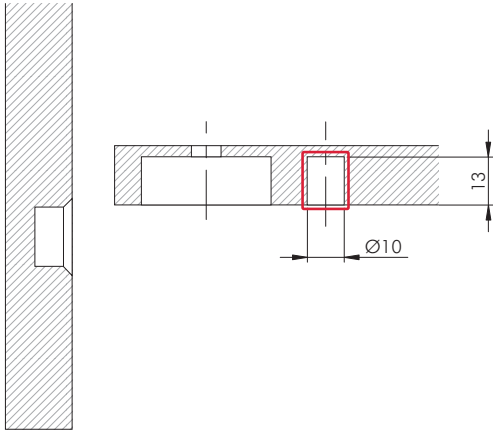

HSS	= on request
3175204000	

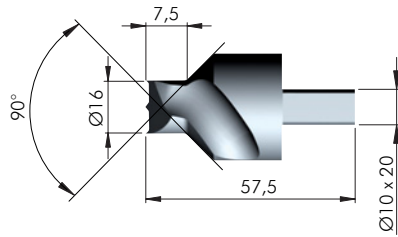
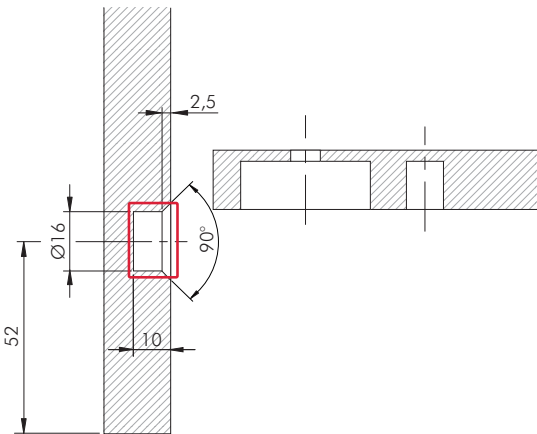

HSS	= on request
3175202000	

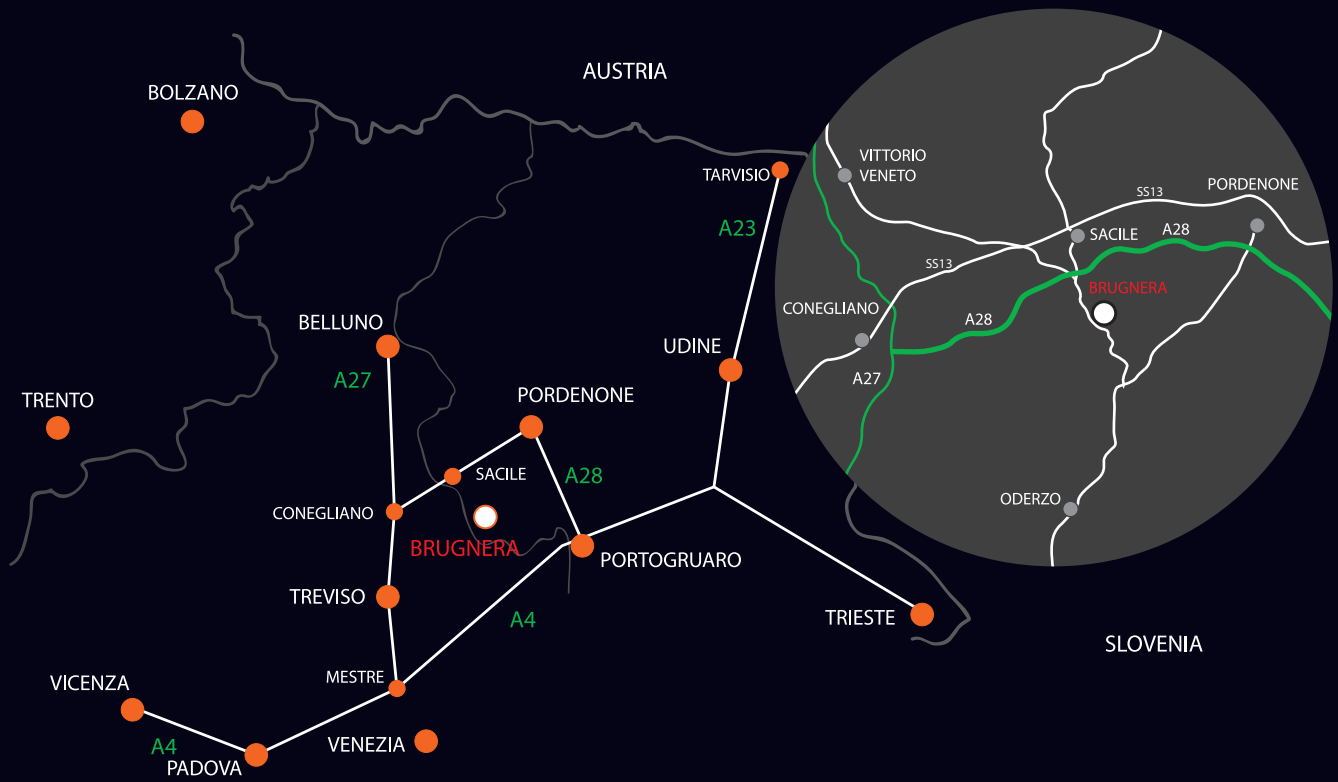

www.italianaferramenta.com