

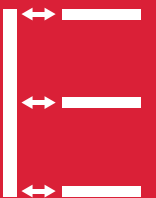

CROSS DOWELS



CONNECTINGS



SYMBOLS AND FINISHES LEGEND

SYMBOLS



= SHELF SAFELY LOCKED DURING TRANSPORTATION AND AT HOME.



= ANTI-TURNOVER LOCKING SYSTEM



= NORMS / PATENTS



= PHILLIPS / POZIDRIV



= NEWTON



= PART.NO



= HEXAGONAL SOCKET



= FRICTION



= PCS. PER PACKAGE



= BLADE SLOT



= AUTOMATIC



= COMBI SLOT



= DROP DOWN



= CAPACITY LOADING



= COUNTERSUNK HEAD



= WOOD / GLASS THICKNESS



= PAN HEAD



= STANDARD HINGE



= HOLE DIAMETER



= FLANGE HEAD



= KIMANA HINGE



= DIAMETER



= FLAT HEAD



= FLAP HINGE



= LENGTH



= TRILOBULAR SCREW



= WITH SPRING



= HEIGHT



= SELF-TAPPING SCREW



= WITHOUT SPRING



= RIGHT VERSION



= EURO THREAD



= REVERSED SPRING



= LEFT VERSION



= METRIC THREAD



= SETTING CODE



= PRE-INSERTED SCREW



= FOR ROUND TUBE



= PCS. PER PAD



= PRE-INSERTED SCREW AND SPREADING BUSH



= FOR OVAL TUBE



= CUT ON REQUEST



= WITH BUFFER



= SELF ADHESIVE



= WITH MAGNET



= WITH FLANGE

NOTE: Printing errors and omissions may exist despite our best efforts to ensure accuracy. We reserve the right to alter specifications without notice.

MATERIALS

| | | | | |
|--|---------------------------------|-------------------------------|-------------------|--|
| ZA = Zinc Alloy | ST = Steel | HSS = High Speed Steel | BR = Brass | ABS = Acrylonitrile Butadiene Styrene |
| ZAnk = Nickel-plated Zinc Alloy | STzk = Zinc-plated Steel | AL = Aluminium | WD = Wood | EVA = Ethylene Vinyl Acetate |

EP = **ENGINEERING PLASTIC**

+ **EP** = other engineering plastic available on request

SR = **SOFT RUBBER**

+ **SR** = other soft rubber available on request

| | | |
|---|--|----------------------------------|
| EPn = Natural Engineering Plastic | EPc = Clear Engineering Plastic | SRn = Natural Soft Rubber |
| EPw = White Engineering Plastic | EPg = Grey Engineering Plastic | SRw = White Soft Rubber |
| EPwg = Water Green Engineering Plastic | | SRb = Black Soft Rubber |



FINISHES



= OTHER FINISHES AVAILABLE ON REQUEST

| PART. NO | FINISHES | PART. NO | FINISHES | PART. NO | FINISHES |
|----------|---------------|----------|--------------------------|----------|------------------------------|
| AA | Natural | JB | Bright Aluminium | QB | Walnut |
| AB | White | JC | Aluminium - Chrome | RO | Red |
| AC | Opal White | JD | Matt Aluminium | UZ | T -Met |
| AE | White 9010 | JE | Satin-finished Aluminium | WA | Bronzed |
| AK | Champagne | JF | Aluminium - Brass | WI | Burnished |
| AL | Ivory | JG | Aluminium 5 | XD | Satin-finished Steel |
| EA | Black | JL | Aluminium PE 11 | YA | Nickel-plated |
| EB | Glossy Black | JM | Aluminium RAL 9006 | YB | Bright Nickel-plated |
| EC | Matt Black | KA | Chrome | YC | Matt Nickel-plated |
| EE | Anthracite | KB | Bright Chrome | YD | Satin-finished Nickel-plated |
| FU | Gunmetal | KC | Matt Chrome | ZA | Zinc alloy |
| GR | Raw | MA | Brown | ZN | Zinc-plated |
| HA | Brass-Plated | MB | Light Brown 1 | ZQ | Bright Gold |
| HH | Tropicalized | NN | Metallic Beige | ZY | Titanium |
| HL | Raw Brass | NO | Beige | ZZ | Clear |
| IA | Grey | OA | Oak | 00 | Insignificant finish |
| IB | Metallic Grey | OZ | Ash | | |
| IF | Middle Grey | PA | Light Ash | | |
| IJ | Light Grey | PZ | Beech | | |
| IL | Grey 20 | QA | Maple | | |

CROSS DOWELS



12 mm min. 

INSTALLATION WITH M6 DOWEL

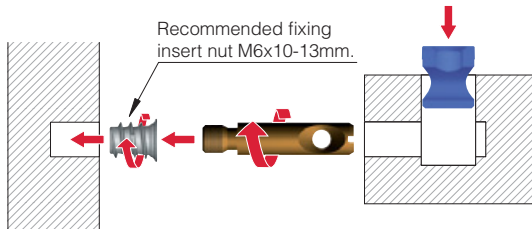

ASSEMBLING

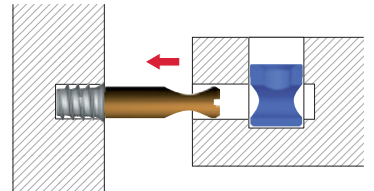

STRUCTURAL FASTENING WITH BLADE 1x5,5 OR CROSS PZ2 SCREWDRIVER.

From the lower side, for the shelves and for the top.

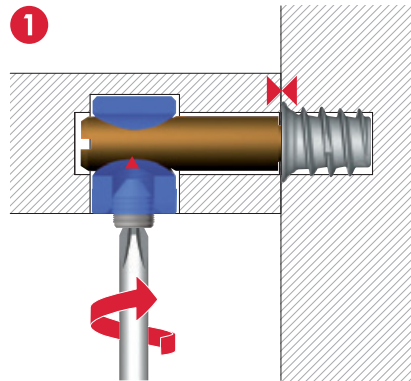



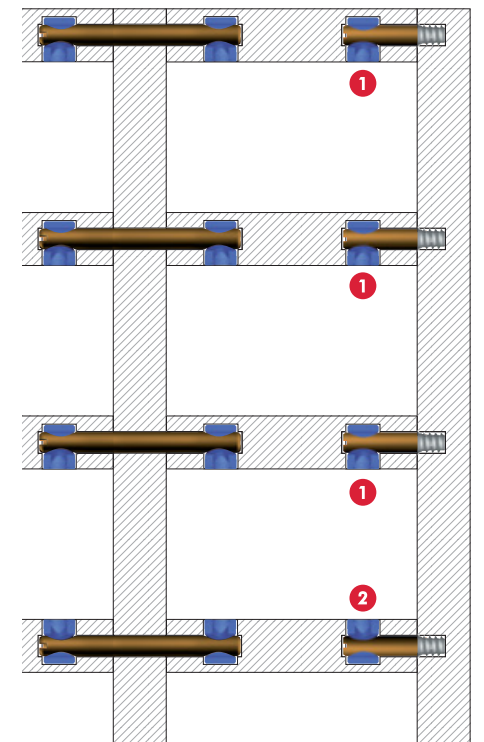
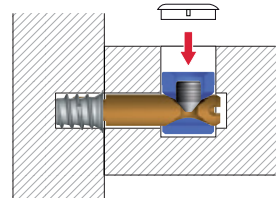
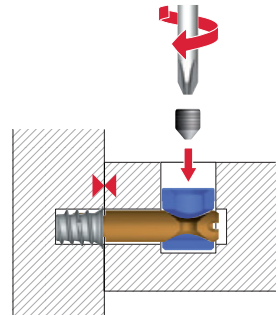
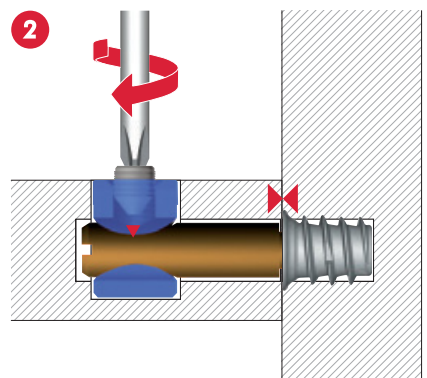





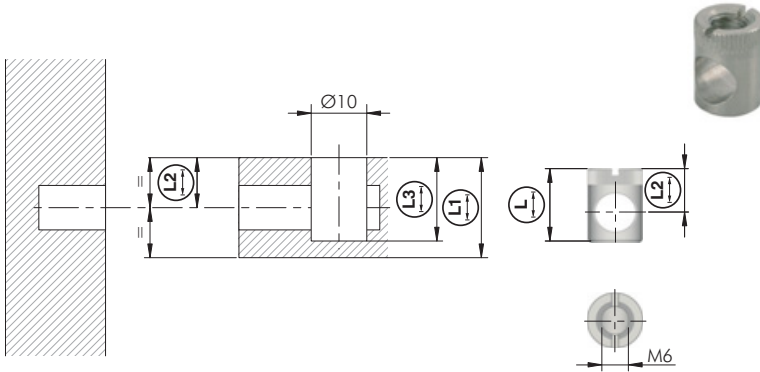



From the upper side, for the furniture floor.













CROSS DOWEL  **10 mm**











| | | | | |
|---|---|---|---|---|
|  = 12 mm min. |  = M6 |   | | |
|  |  = 2000 pcs. | | | |
|   |  |  |  |  |
| 21001040Zn | 10,5 | 12 | 6 | 11 |
| 21001010Zn | 14 | 18 | 9 | 15 |



| | | | |
|---|---|---|--|
|  = M6 |  = 1x5,5 mm |   | |
|  |  = 10.000 pcs. | | |
|   | | | |
| 21101010Zn | | | |

NOTE: to be used for Part no. 21001010Zn







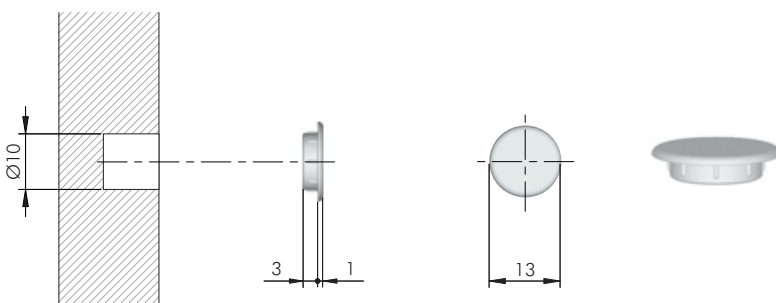

| | | |
|---|---|---|
|  = M6 |  = PZ2 |   |
|  |  = 20.000 pcs. | |
|   | | |
| 16215A10Zn | | |

NOTE: to be used for Part no. 21001040Zn

CROSS DOWEL  **10 mm ACCESSORY**





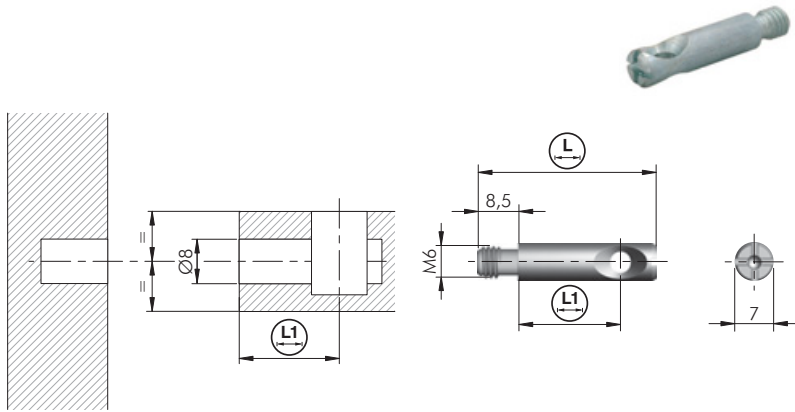

| | |
|---|---|
|  = Ø 10 mm |   |
|  |  = 5000 pcs. |
|   | |
| 23002020AB | |
| 23002020EA | |



DOWELS FOR CROSS DOWEL 10 mm





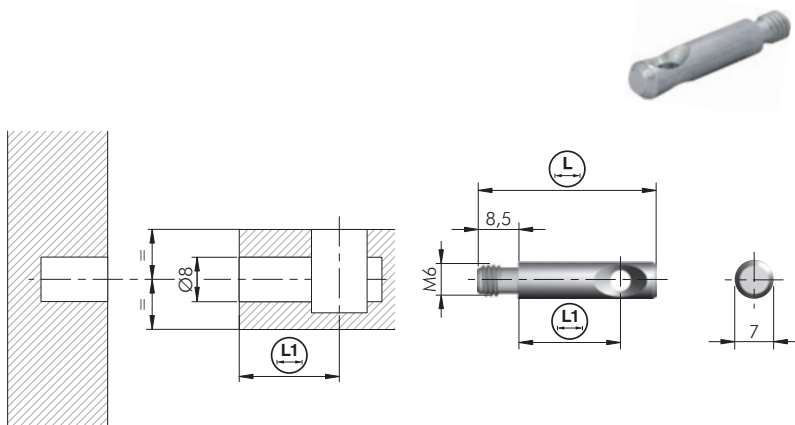

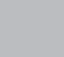
| | | |
|--|---|---|
|  = M6 |  |  = 2000 pcs. |
| ST | | |

| | | |
|---|---|---|
|   |  |  |
| 21201010Z N | 32 | 18 |
| 21201030Z N | 45 | 28 |





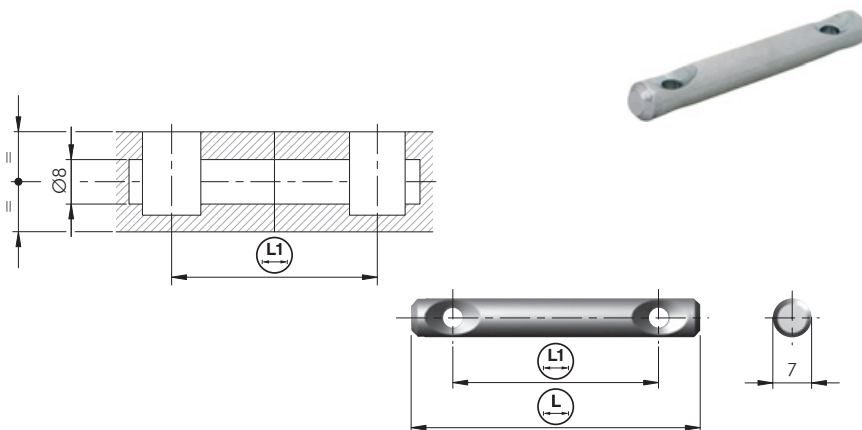

| | | |
|---|--|---|
|  = M6 |  |  = 2000 pcs. |
| ST | | |

| | | |
|---|---|---|
|   |  |  |
| 21201040Z N | 45,5 | 30 |
| 21201090Z N | 57,5 | 42 |











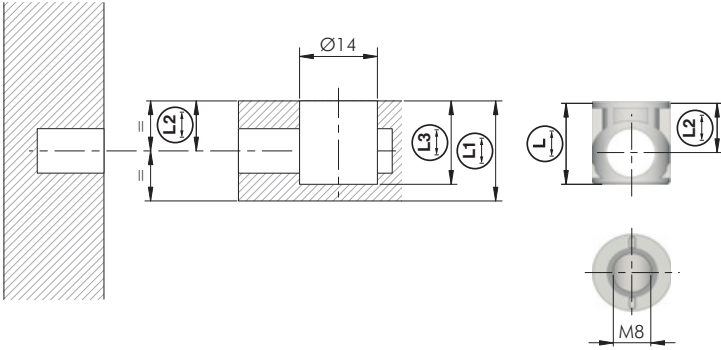

| | |
|----|---|
| ST |  = 2000 pcs. |
|----|---|

| | | | |
|---|---|---|---|
|   |  |  |  |
| 21202010Z N | 52 | 37 | 1000 |
| 21202020Z N | 62 | 42 | 1000 |
| 21202110Z N | 97 | 82 | 500 |
| 21202140Z N | 109 | 96 | 500 |









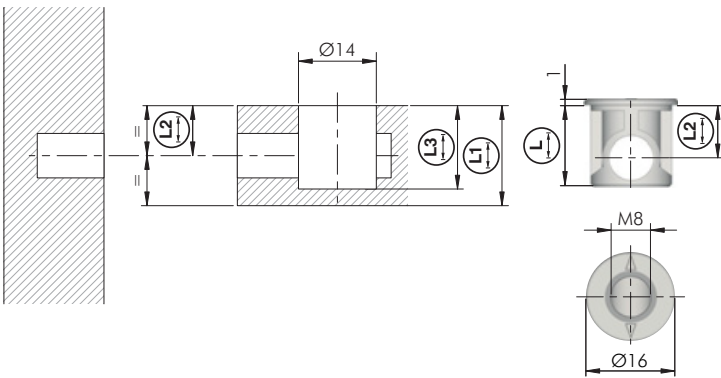



CROSS DOWEL  **14 mm**







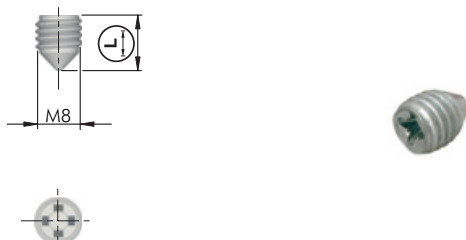

| | | | | |
|---|---|---|---|---|
|  = 16 mm min. |  = M8 |  | | |
| ZA |  = 2000 pcs. | | | |
|   |  |  |  |  |
| 21002010Z N | 14 | 16 | 8 | 14 |
| 21004010Z N | 14 | 18 | 9 | 15 |
| 21002080Z N | 16 | 20 | 10 | 17 |
| 21002040Z N | 17 | 22 | 11 | 18 |
| 21002050Z N | 19 | 25 | 12,5 | 20 |



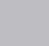

| | | | | |
|---|---|---|---|---|
|  = 16 mm min. |  = M8 |  |  | |
| ZA |  = 2000 pcs. | | | |
|   |  |  |  |  |
| 21003010Z N | 14 | 16 | 8 | 14 |
| 21005010Z N | 15 | 18 | 9 | 15 |
| 21003030Z N | 16 | 20 | 10 | 17 |
| 21003100Z N | 17 | 22 | 11 | 18 |
| 21003050Z N | 19 | 25 | 12,5 | 20 |

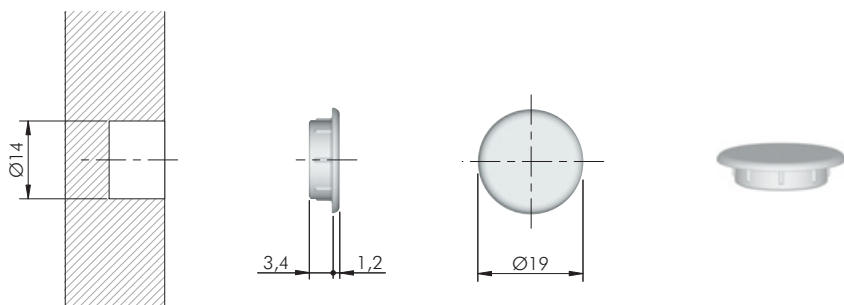

| | | | |
|---|---|---|--|
|  = M8 |  = PZ2 |  | |
| ZA |  = 5000 pcs. | | |
|   |  | | |
| 21102030Z N | 10 | | |
| 21102020Z N | 15 | | |

CROSS DOWEL 14 mm ACCESSORY

 = Ø 14 mm



EP

 = 5000 pcs.

23004010AB

23004010EA

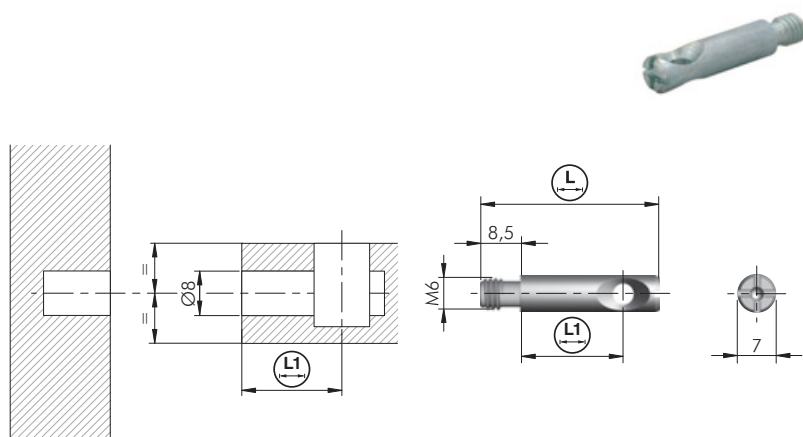
DOWELS FOR CROSS DOWEL 14 mm

 = M6

ST

 = 2000 pcs.

21201010ZN



32



18

21201030ZN

45

28

21201150ZN

36

20

21201160ZN

44

28

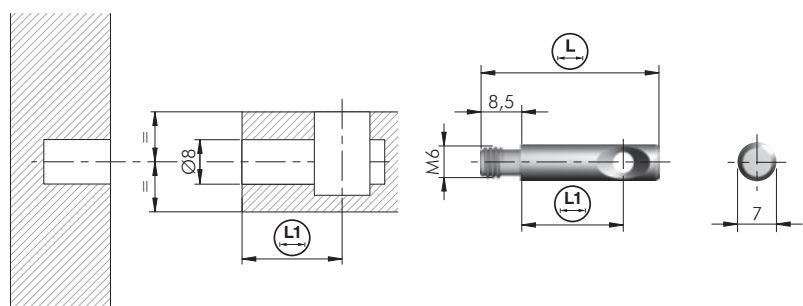
 = M6

ST

 = 2000 pcs.

21201040ZN



45,5



30

21201090ZN

57,5

42

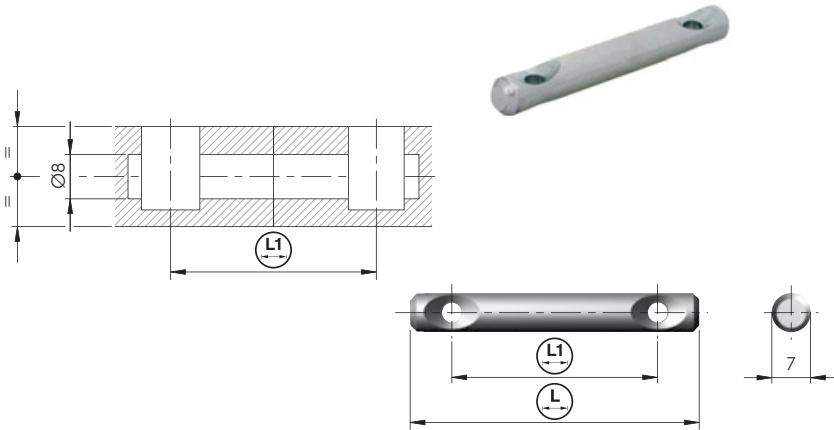



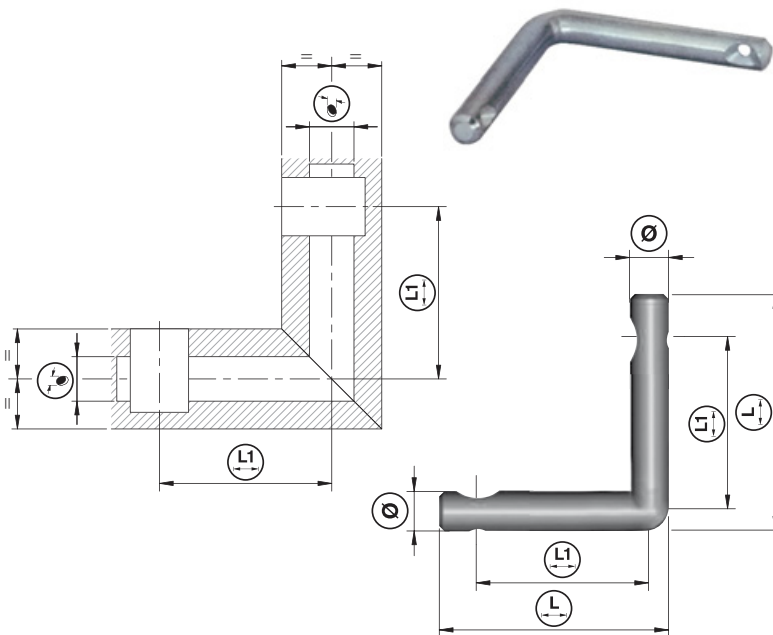



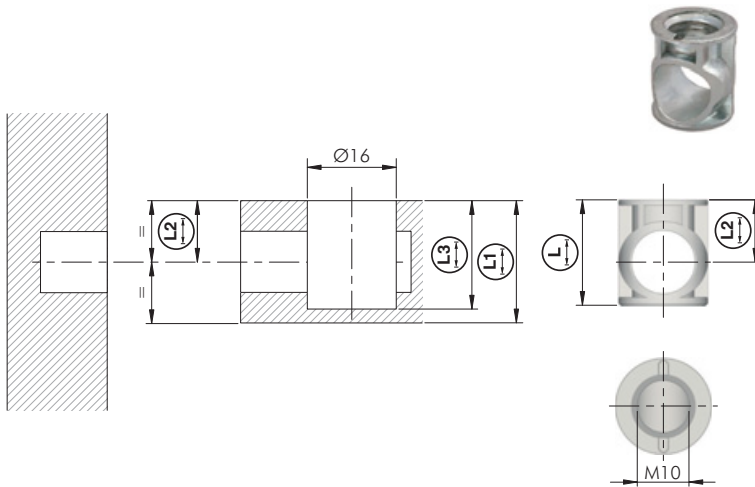



| ST | | | | |
|------------|--|-----|----|------|
| | | | | |
| 21202010Zn | | 52 | 37 | 1000 |
| 21202020Zn | | 62 | 42 | 1000 |
| 21202110Zn | | 97 | 82 | 500 |
| 21202140Zn | | 109 | 96 | 500 |









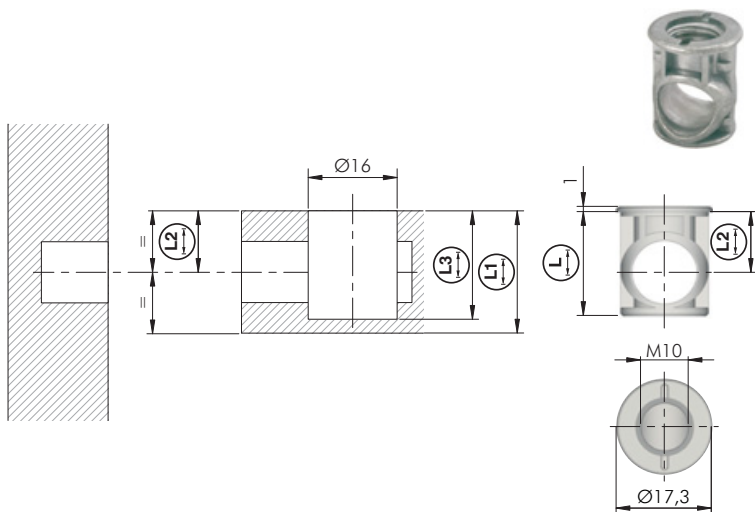



| ST | | | | = 1000 pcs. | |
|------------|--|----|----|-------------|---|
| | | | | | |
| 21405020Zn | | 39 | 31 | 8 | 7 |
| 21405030Zn | | 75 | 64 | 9 | 8 |





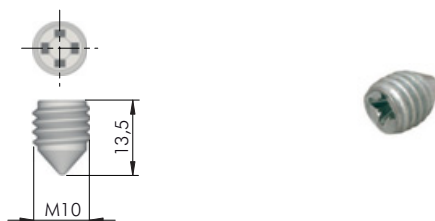

CROSS DOWEL  **16 mm**

| | | | | |
|--|---|---|---|---|
|  = 22 mm min. |  = M10 |  = 2000 pcs. | | |
| ZA |  | | | |
|   |  |  |  |  |
| 21008050Z N | 19,5 | 22 | 11 | 19,5 |
| 21008030Z N | 20,5 | 24 | 12 | 21 |
| 21008040Z N | 21,5 | 26 | 13 | 22 |



| | | | | |
|--|---|---|---|---|
|  = 22 mm min. |  = M10 |  |  = 2000 pcs. | |
| ZA |  | | | |
|   |  |  |  |  |
| 21009070Z N | 19,5 | 22 | 11 | 19,5 |
| 21009040Z N | 20,5 | 24 | 12 | 21 |
| 21009060Z N | 21,5 | 26 | 13 | 22 |
| 21009030Z N | 23,5 | 30 | 15 | 24 |



| | | | | |
|---|---|---|--|--|
|  = M10 |  = PZ2 |  = 5000 pcs. | | |
| ZA |  | | | |
|   | | | | |
| 21104020Z N | | | | |



CROSS DOWEL  16 mm ACCESSORY

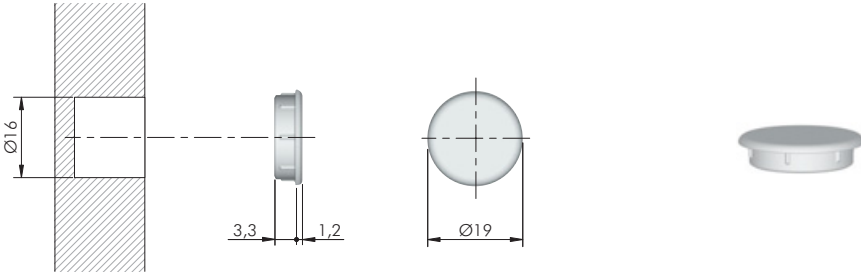

 = Ø 16 mm



EP

 = 10.000 pcs.



23004030AB

23004030EA

DOWELS FOR CROSS DOWEL  16 mm

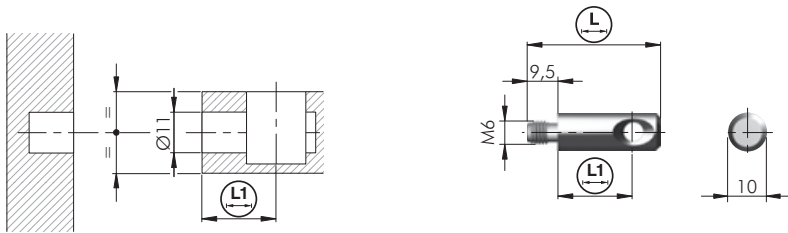

 = M6

ST



21204010ZN

36

20

2000

21204020ZN

43,5

26,5

1000

21204040ZN

46

30

1000

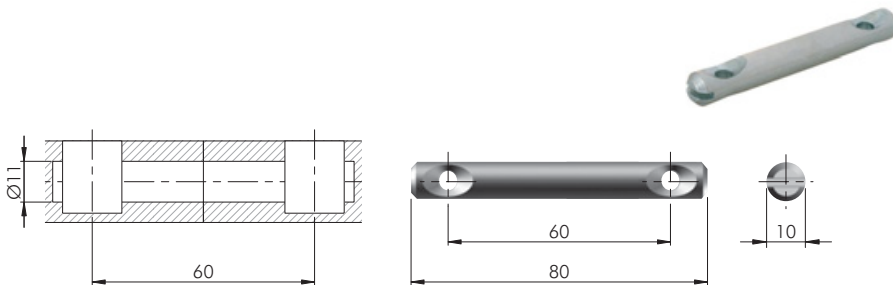

ST

 = 500 pcs.



21202030ZN

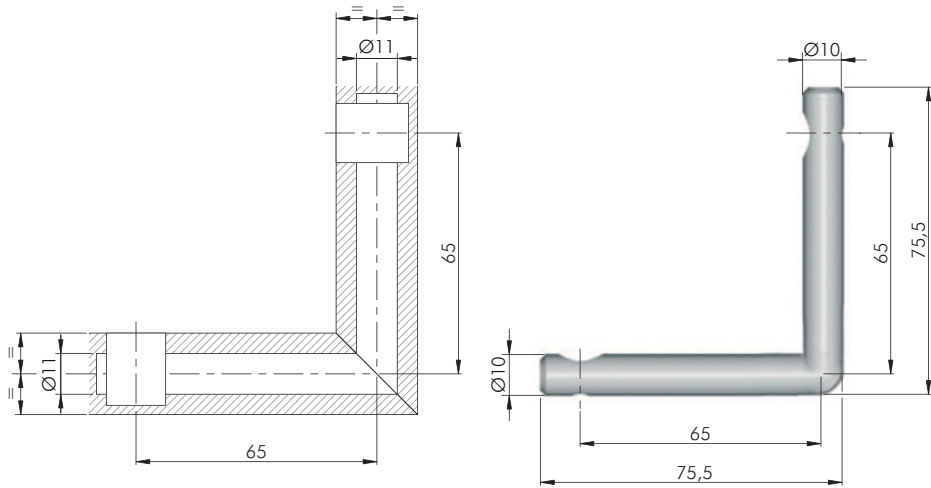

ST = 1000 pcs.

123 21203040Zn



CROSS DOWELS FIXING ACCESSORIES

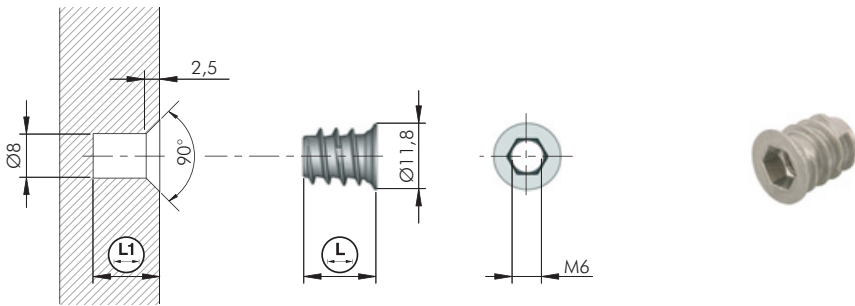

= Ø 8 mm = M6 +

= S6

ZA = 5000 pcs.

| | | |
|------------|----|----|
| | | |
| 20102010GR | 10 | 12 |
| 20102020GR | 13 | 15 |

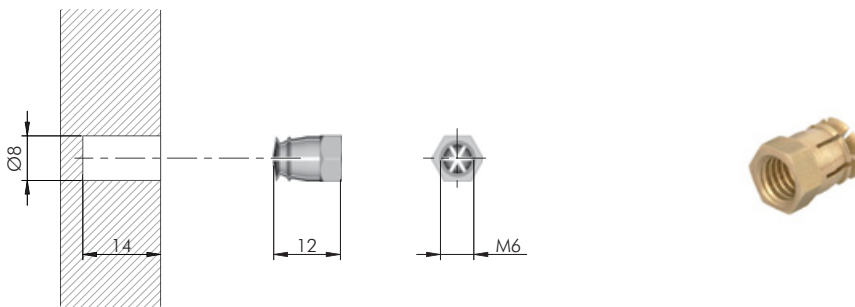

= Ø 8 mm = M6

BR = 5000 pcs.

20506020HL

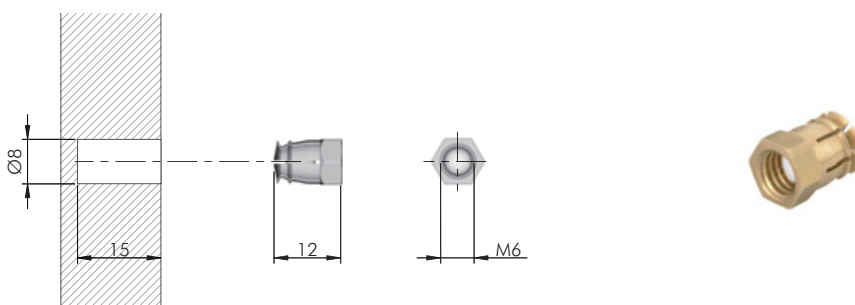

= Ø 8 mm = M6

BR EP = 10.000 pcs.

20507061HL



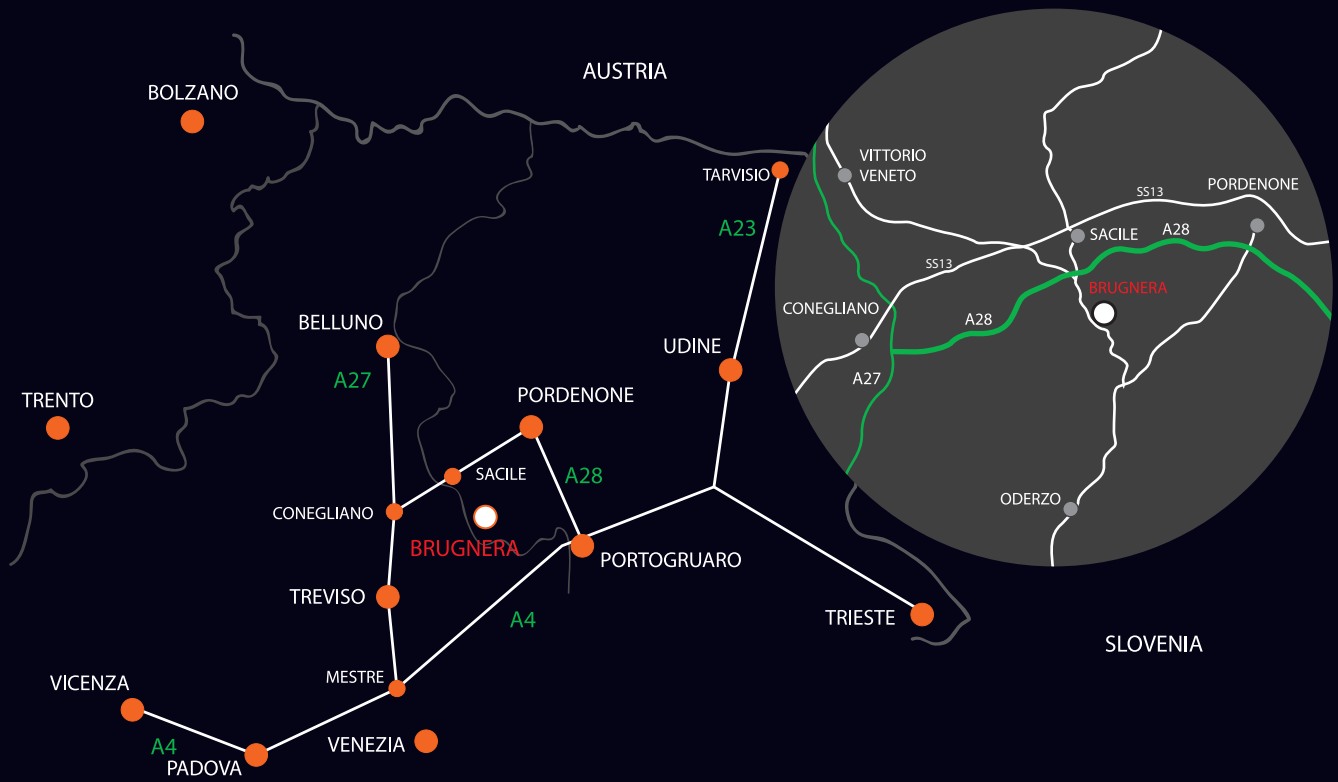

www.italianaferramenta.com