

PK2 SIDE BRACKET ROUND LEDGE

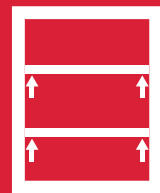

SHELF
SUPPORTS



SYMBOLS AND FINISHES LEGEND

SYMBOLS

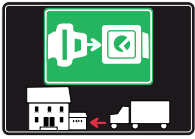

= SHELF SAFELY LOCKED DURING TRANSPORTATION AND AT HOME



= ANTI-TURNOVER LOCKING SYSTEM



= NORMS / PATENTS



= PHILLIPS / POZIDRIV



= NEWTON



= PART.NO



= HEXAGONAL SOCKET



= FRICTION



= PCS. PER PACKAGE



= BLADE SLOT



= AUTOMATIC



= CAPACITY LOADING



= COUNTERSUNK HEAD



= WOOD / GLASS THICKNESS



= PAN HEAD



= STANDARD HINGE



= HOLE DIAMETER



= FLANGE HEAD



= KIMANA HINGE



= DIAMETER



= FLAT HEAD



= FLAP HINGE



= LENGTH



= TRILOBULAR SCREW



= WITH SPRING



= HEIGHT



= SELF-TAPPING SCREW



= WITHOUT SPRING



= RIGHT VERSION



= EURO THREAD



= REVERSED SPRING



= LEFT VERSION



= METRIC THREAD



= SETTING CODE



= PRE-INSERTED SCREW



= FOR ROUND TUBE



= PCS. PER PAD



= PRE-INSERTED SCREW AND SPREADING BUSH



= FOR OVAL TUBE



= CUT ON REQUEST



= WITH BUFFER



= SELF ADHESIVE



= WITH MAGNET



= WITH FLANGE

MATERIALS

ZA = Zinc Alloy	ST = Steel	HSS = High Speed Steel	BR = Brass	ABS = Acrylonitrile Butadiene Styrene
ZAnk = Nickel-plated Zinc Alloy	STzk = Zinc-plated Steel	AL = Aluminium	WD = Wood	EVA = Ethylene Vinyl Acetate

EP = **ENGINEERING PLASTIC**

+ **EP** = other engineering plastic available on request

SR = **SOFT RUBBER**

+ **SR** = other soft rubber available on request

EPn = Natural Engineering Plastic	EPc = Clear Engineering Plastic	SRn = Natural Soft Rubber
EPw = White Engineering Plastic	EPg = Grey Engineering Plastic	SRw = White Soft Rubber
EPwg = Water Green Engineering Plastic		SRb = Black Soft Rubber

FINISHES

+  = OTHER FINISHES AVAILABLE ON REQUEST

PART. NO	FINISHES	PART. NO	FINISHES	PART. NO	FINISHES
AA	Natural	JB	Bright Aluminium	QA	Maple
AB	White	JC	Aluminium - Chrome	QB	Walnut
AC	Opal White	JD	Matt Aluminium	UZ	T -Met
AE	White 9010	JE	Satin-finished Aluminium	WA	Bronzed
AK	Champagne	JF	Aluminium - Brass	WI	Burnished
AL	Ivory	JG	Aluminium 5	XD	Satin-finished Steel
EA	Black	JL	Aluminium PE 11	YA	Nickel-plated
EB	Glossy Black	JM	Aluminium RAL 9006	YB	Bright Nickel-plated
EC	Matt Black	KA	Chrome	YC	Matt Nickel-plated
FU	Gunmetal	KB	Bright Chrome	YD	Satin-finished Nickel-plated
GR	Raw	KC	Matt Chrome	ZA	Zinc alloy
HA	Brass-Plated	MA	Brown	ZN	Zinc-plated
HH	Tropicalized	MB	Light Brown 1	ZQ	Bright Gold
HL	Raw Brass	NN	Metallic Beige	ZY	Titanium
IA	Grey	NO	Beige	ZZ	Clear
IB	Metallic Grey	OA	Oak	00	Insignificant finish
IF	Middle Grey	OZ	Ash		
IJ	Light Grey	PA	Light Ash		
IL	Grey 20	PZ	Beech		



**PK2 FOR 18 - 19 mm SHELF
SIDE BRACKET ROUND LEDGE**

New connecting fitting for the complete cabinet construction (base shelves and top) providing structural fastening.

Suitable for heavy duty wardrobes, bookcases, modular furniture, office furniture and dismantled furniture (Do It by Yourself).

Available for 18 - 19 mm thick panels minimum.

Consists of two separate parts: zinc alloy side bracket and plastic shelf support with zinc alloy minifix inside to be slotted into the shelf.

Shelf is subsequently vertically pressed and clicks onto the side bracket.

The rounded side bracket ledge can flush with the lower side of the shelf, by operating a face boring, making the result aesthetically very elegant.

Shelf and top panel connection to be carried out by turning the mini fix 90° from the under side.

Optional through hole Ø8 mm for connecting also the bottom panel to be carried out by turning the minifix 90° from the upper side.

Side bracket available as plain version for euro screw,

countersunk screw, M4 dowel with spreading dowel or with pre-inserted spreading bush and screw for shelf repositioning without damaging the hole.

A plastic cover cap can be used to conceal the housing on the bottom.

In accordance with the European regulations UNI EN 14749/05.



18 - 19 mm min.

UNI EN 14749/05 and UNI 8603/05

INSTALLATION AND ASSEMBLING

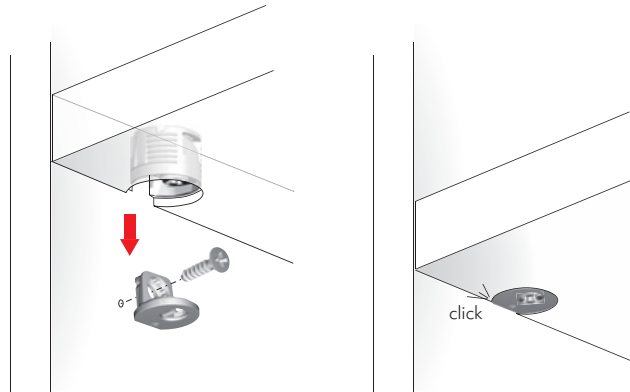
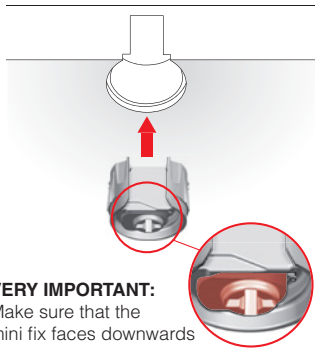

**STRUCTURAL FASTENING WITH
CROSS PZ2 SCREWDRIVER:**

90° turning from the upper side, for the furniture floor.

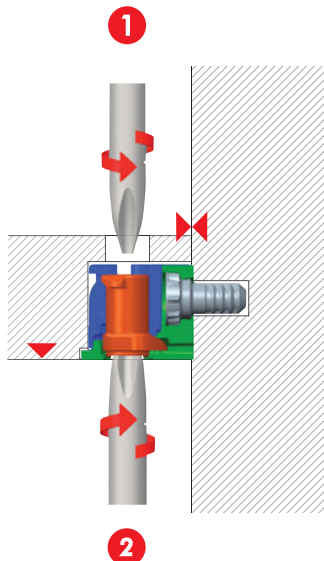

90° turning from the lower side, for the shelves and for the top.

Assembling with alternative fixing options.

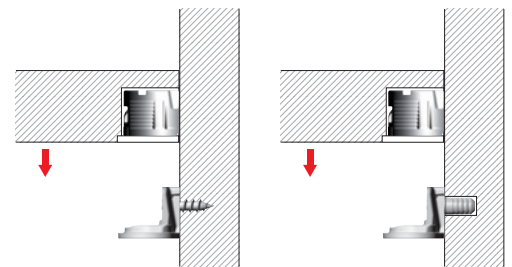

Assembling with pre-inserted spreading bush and screw to avoid hole damaging for shelf repositioning.

LOCKING DETAIL:

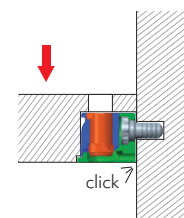

After turning the minifix.

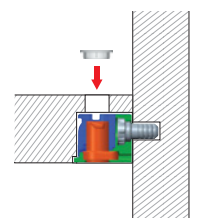

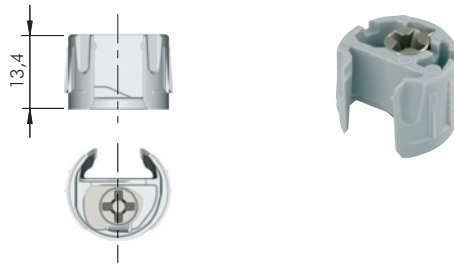
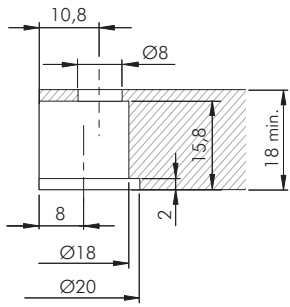

ZA

EP

= 2500 pcs.



11401010IJ

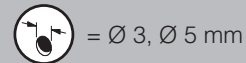
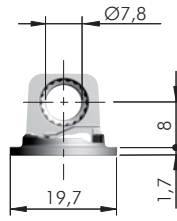
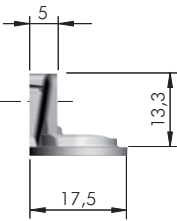
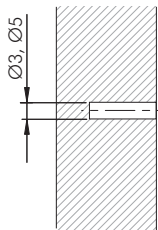

ZA

= 2500 pcs.



11402110YA

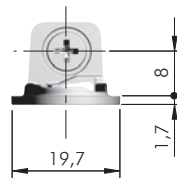
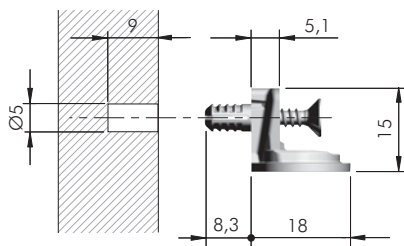

ZA

ST

EP

= 2500 pcs.



11402120YA

DRILL BIT FOR PK2 SIDE BRACKET ROUND LEDGE

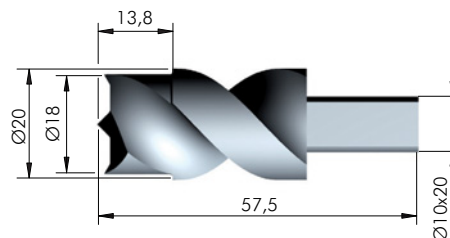
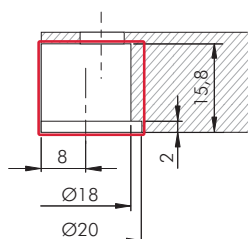

HSS

= on request



1145203000

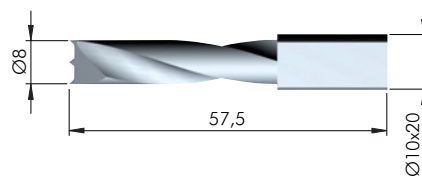
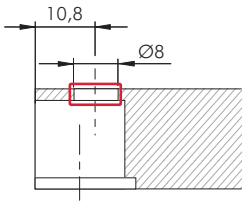

HSS = on request

123 |

1145202000

PK2 SIDE BRACKET ROUND LEDGE ACCESSORY

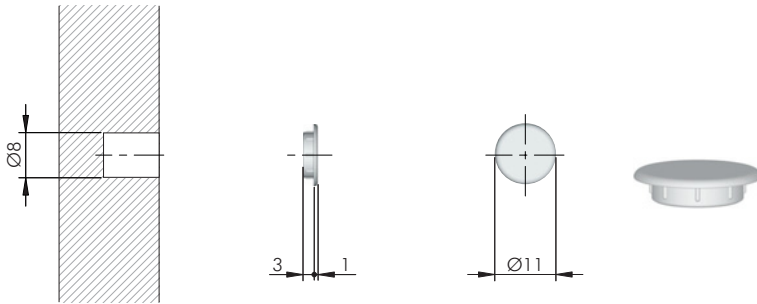

= Ø 8 mm +

EP = 5000 pcs.

123 |

23002010AB

PK2 SIDE BRACKET ROUND LEDGE FIXING ACCESSORIES

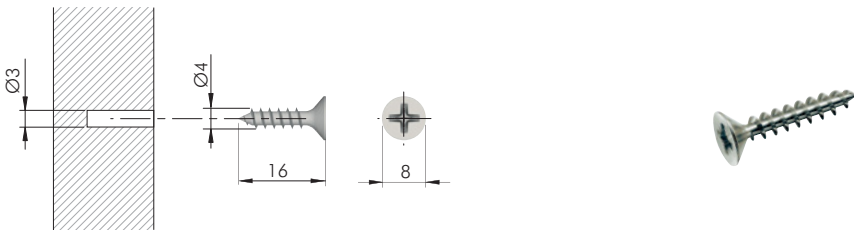

= Ø 3 mm

= PZ2

ST = 5000 pcs.

123 |

60101570ZN

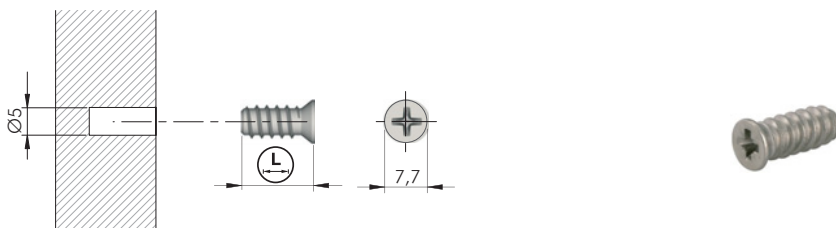

= Ø 5 mm +

= PZ2

ST

123	L	
60502010ZN	10	9000
60501050YA	12,7	5000
60502020ZN	13	5000
60502030ZN	15	5000

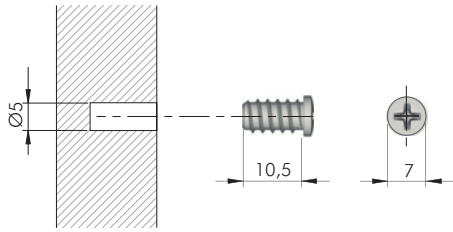

= $\varnothing 5$ mm +
 = PZ2
 = 5000 pcs.

60507010YA

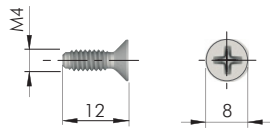

= M4 = PZ2
 = 2000 pcs.

60305040ZN

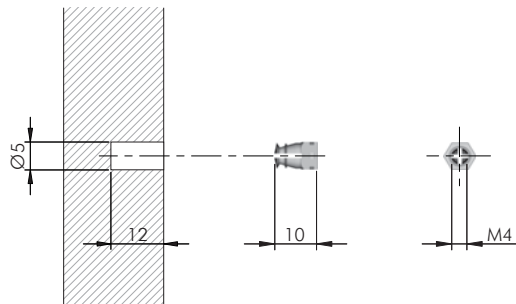

= $\varnothing 5$ mm = M4
 = 20.000 pcs.

20502021HL

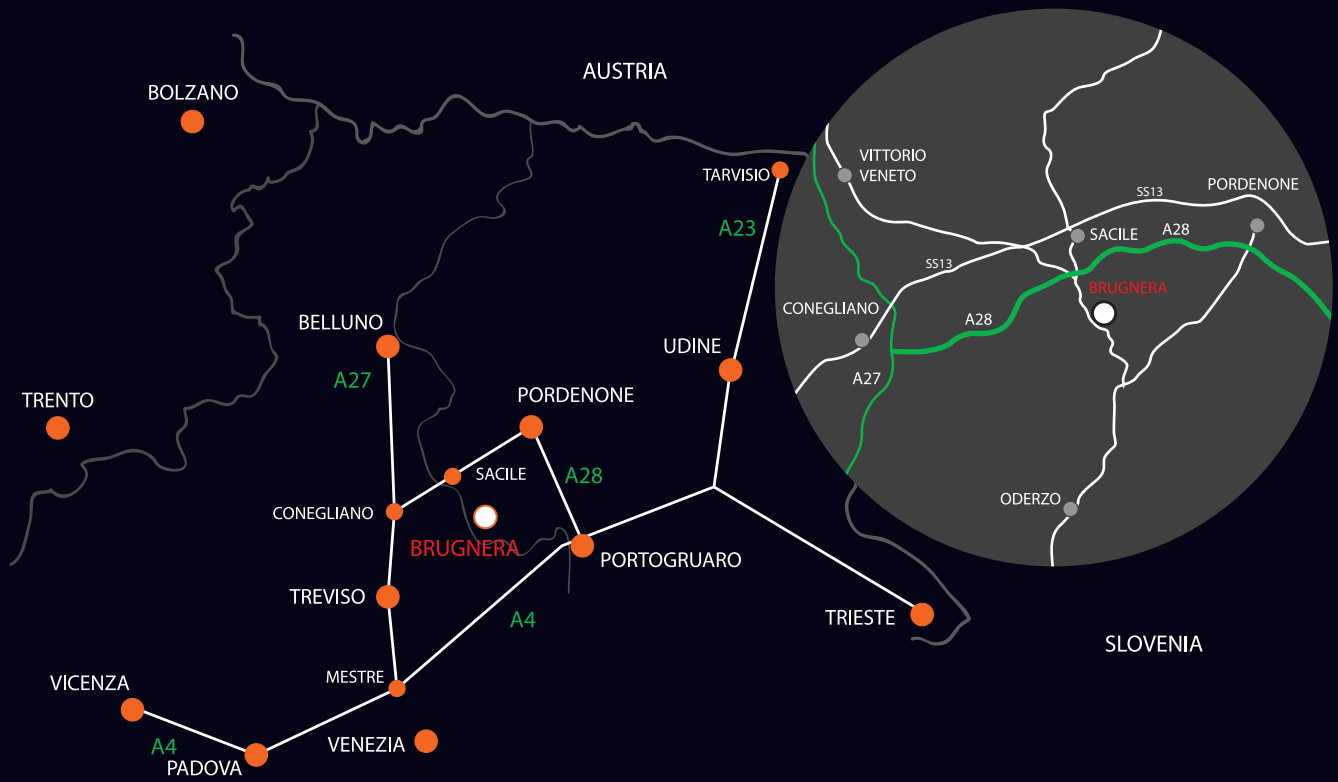

www.italianaferramenta.com