

POKER



SHELF  
SUPPORTS





# SYMBOLS AND FINISHES LEGEND

## SYMBOLS



= SHELF SAFELY LOCKED DURING TRANSPORTATION AND AT HOME.



= ANTI-TURNOVER LOCKING SYSTEM



= NORMS / PATENTS



= PHILLIPS / POZIDRIV



= NEWTON



= PART.NO



= HEXAGONAL SOCKET



= FRICTION



= PCS. PER PACKAGE



= BLADE SLOT



= AUTOMATIC



= COMBI SLOT



= DROP DOWN



= CAPACITY LOADING



= COUNTERSUNK HEAD



= WOOD / GLASS THICKNESS



= PAN HEAD



= STANDARD HINGE



= HOLE DIAMETER



= FLANGE HEAD



= KIMANA HINGE



= DIAMETER



= FLAT HEAD



= FLAP HINGE



= LENGTH



= TRILOBULAR SCREW



= WITH SPRING



= HEIGHT



= SELF-TAPPING SCREW



= WITHOUT SPRING



= RIGHT VERSION



= EURO THREAD



= REVERSED SPRING



= LEFT VERSION



= METRIC THREAD



= SETTING CODE



= PRE-INSERTED SCREW



= FOR ROUND TUBE



= PCS. PER PAD



= PRE-INSERTED SCREW AND SPREADING BUSH



= FOR OVAL TUBE



= CUT ON REQUEST



= WITH BUFFER



= SELF ADHESIVE



= WITH MAGNET



= WITH FLANGE

NOTE: Printing errors and omissions may exist despite our best efforts to ensure accuracy. We reserve the right to alter specifications without notice.

## MATERIALS

<b>ZA</b> = Zinc Alloy	<b>ST</b> = Steel	<b>HSS</b> = High Speed Steel	<b>BR</b> = Brass	<b>ABS</b> = Acrylonitrile Butadiene Styrene
<b>ZAnk</b> = Nickel-plated Zinc Alloy	<b>STzk</b> = Zinc-plated Steel	<b>AL</b> = Aluminium	<b>WD</b> = Wood	<b>EVA</b> = Ethylene Vinyl Acetate

**EP** = **ENGINEERING PLASTIC**

+ **EP** = other engineering plastic available on request

**SR** = **SOFT RUBBER**

+ **SR** = other soft rubber available on request

<b>EPn</b> = Natural Engineering Plastic	<b>EPc</b> = Clear Engineering Plastic	<b>SRn</b> = Natural Soft Rubber
<b>EPw</b> = White Engineering Plastic	<b>EPg</b> = Grey Engineering Plastic	<b>SRw</b> = White Soft Rubber
<b>EPwg</b> = Water Green Engineering Plastic		<b>SRb</b> = Black Soft Rubber



## FINISHES



= OTHER FINISHES AVAILABLE ON REQUEST

PART. NO	FINISHES	PART. NO	FINISHES	PART. NO	FINISHES
AA	Natural	JB	Bright Aluminium	QB	Walnut
AB	White	JC	Aluminium - Chrome	RO	Red
AC	Opal White	JD	Matt Aluminium	UZ	T -Met
AE	White 9010	JE	Satin-finished Aluminium	WA	Bronzed
AK	Champagne	JF	Aluminium - Brass	WI	Burnished
AL	Ivory	JG	Aluminium 5	XD	Satin-finished Steel
EA	Black	JL	Aluminium PE 11	YA	Nickel-plated
EB	Glossy Black	JM	Aluminium RAL 9006	YB	Bright Nickel-plated
EC	Matt Black	KA	Chrome	YC	Matt Nickel-plated
EE	Anthracite	KB	Bright Chrome	YD	Satin-finished Nickel-plated
FU	Gunmetal	KC	Matt Chrome	ZA	Zinc alloy
GR	Raw	MA	Brown	ZN	Zinc-plated
HA	Brass-Plated	MB	Light Brown 1	ZQ	Bright Gold
HH	Tropicalized	NN	Metallic Beige	ZY	Titanium
HL	Raw Brass	NO	Beige	ZZ	Clear
IA	Grey	OA	Oak	00	Insignificant finish
IB	Metallic Grey	OZ	Ash		
IF	Middle Grey	PA	Light Ash		
IJ	Light Grey	PZ	Beech		
IL	Grey 20	QA	Maple		



## POKER

**POKER** is the new concept in wood shelf supports, to be slotted into the panel by making edge borings.

It allows to join together any side and shelf, including bottom and top, without using any further connecting fitting. The sleeve expands by inserting the provided pin, which improves the structural fastening of the panel to the sides of the furniture. The panel has to be pushed downwards onto the side brackets, which can be screwed into any position required.

The side bracket slots into the socket of the shelf supports and a click locks the panel in position.

By turning the mini fix placed inside the shelf support 90° anticlockwise from the bottom, the shelf and top panel collide with the sides, providing a structural fastening.

An optional through hole Ø 8 mm allows you to fix also the bottom panel from the top by turning the mini fix 90° anticlockwise.

In accordance with the regulation: UNI EN 14749/05.



18 mm min

UNI EN 14749/05

### INSTALLATION AND ASSEMBLING

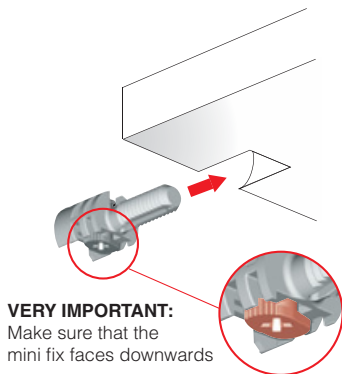

**VERY IMPORTANT:**  
Make sure that the mini fix faces downwards

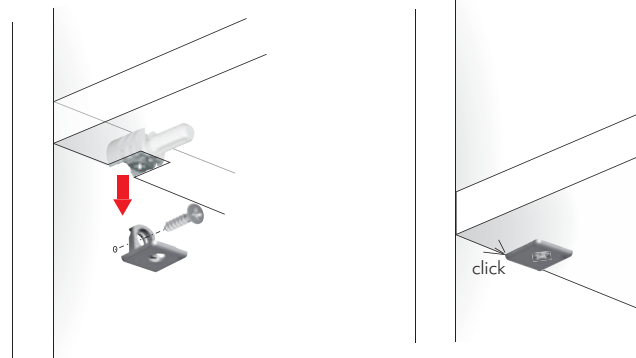

The sleeve expands by inserting the pre-mounted pin.

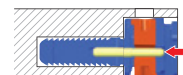

### STRUCTURAL FASTENING WITH CROSS PH2 SCREWDRIVER:

90° turning from the upper side, for the furniture floor.

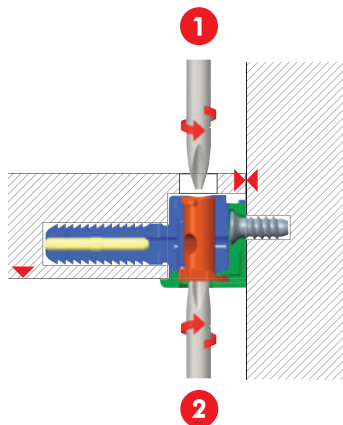

90° turning from the lower side, for the shelves and for the top.

Assembling with alternative screw options.

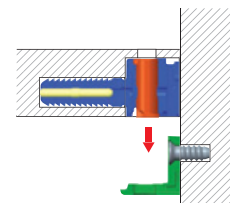

Assembling with pre-inserted spreading bush and screw to avoid hole damaging for shelf repositioning.

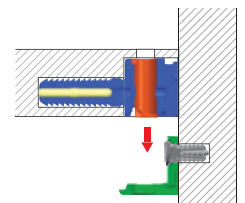

### LOCKING DETAIL:

After turning the minifix.

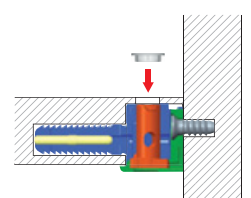
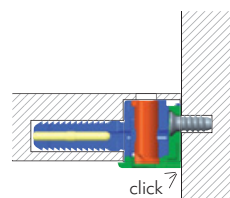



**POKER**  **18 mm**

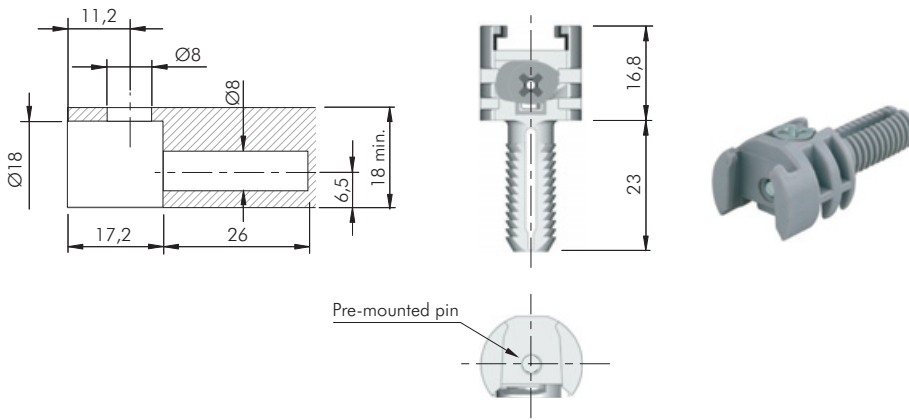

11301010IL

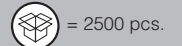
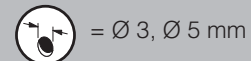
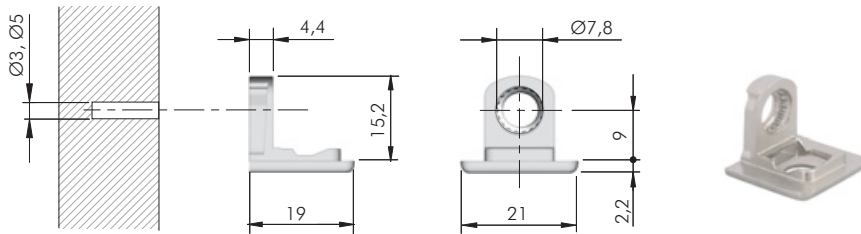

11302010YA

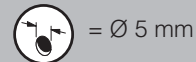
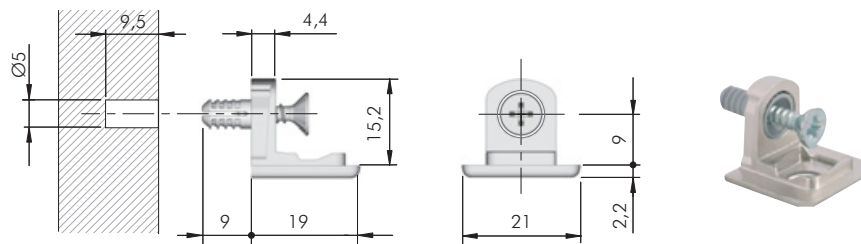

11302020YA

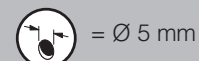
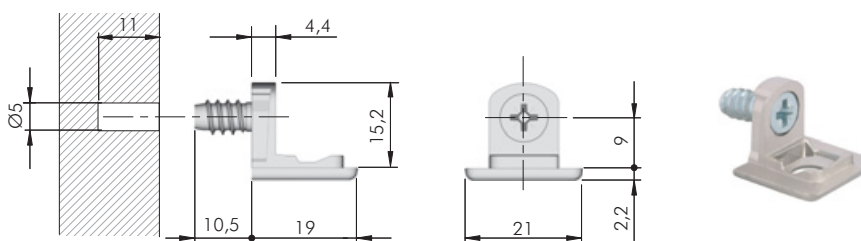

11302030YA

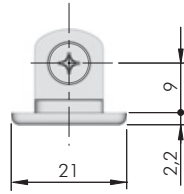
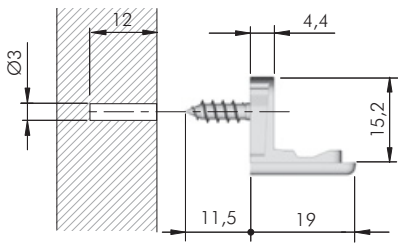

= Ø 3 mm +   
 = PZ2  
 ZA ST  = 2500 pcs.

11302050YA

## DRILL BIT FOR POKER 18 mm

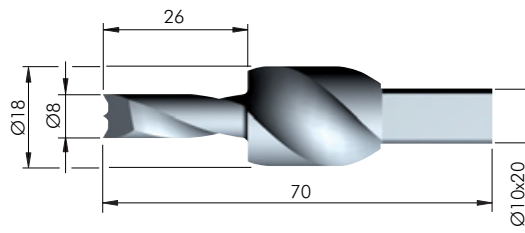
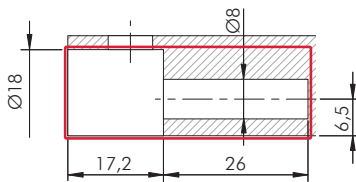

HSS  = on request  
  
 1135010000   
 1135020000

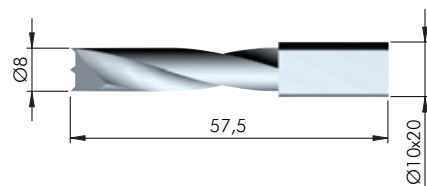
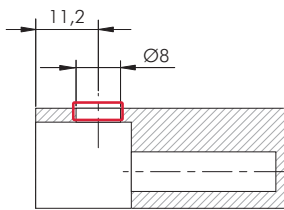

HSS  = on request  
  
 1145202000



**POKER**  **25 mm**

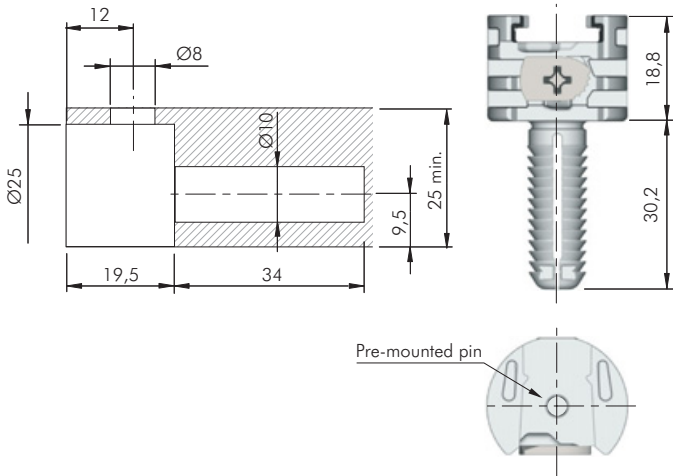

11301030IL

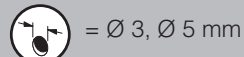
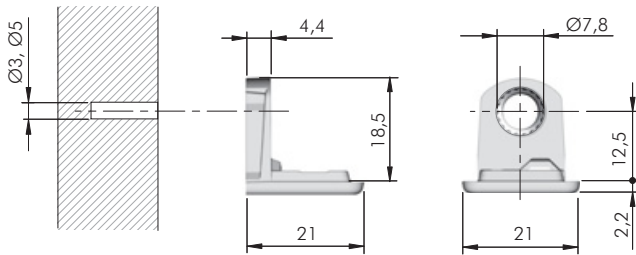

11303010YA

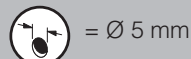
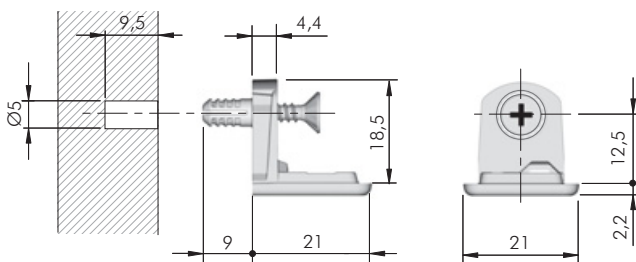

11303020YA

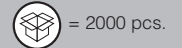
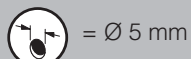
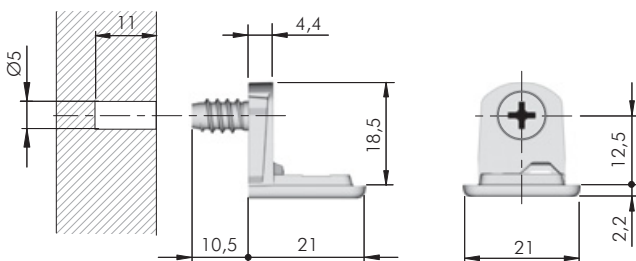

11303030YA

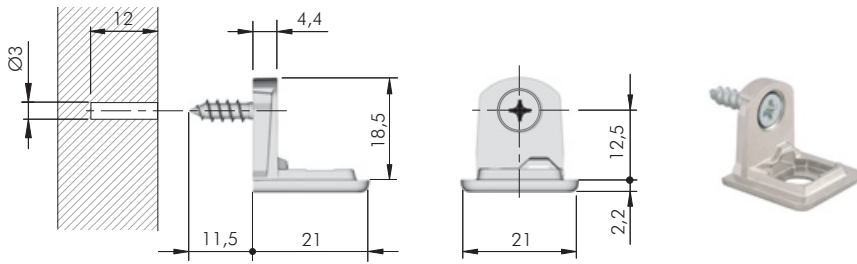

= Ø 3 mm +   
 = PZ2  
 ZA ST  = 2000 pcs.

---

11303050YA

## POKER 28 mm

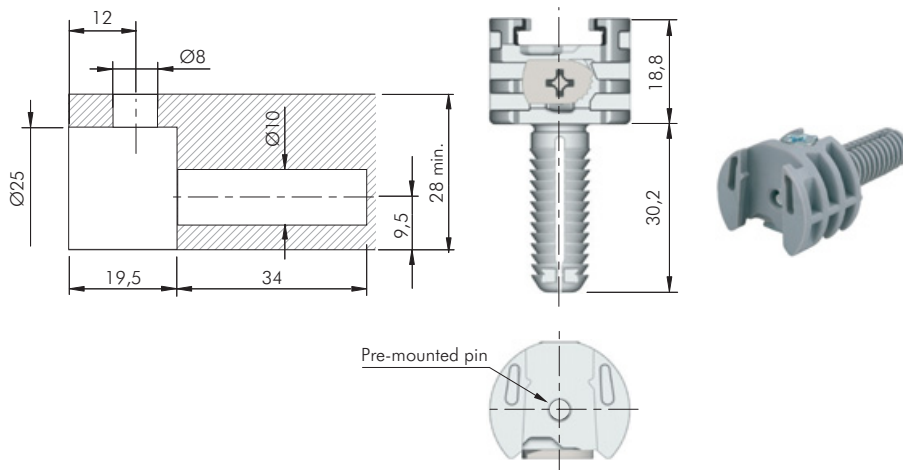

= PH2  
 ZA EP ST  = 2000 pcs.

---

11301030IL

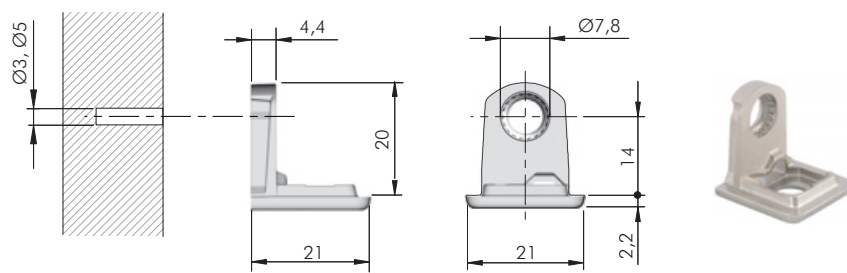

= Ø 3, Ø 5 mm +   
 ZA  = 2000 pcs.

---

11304010YA

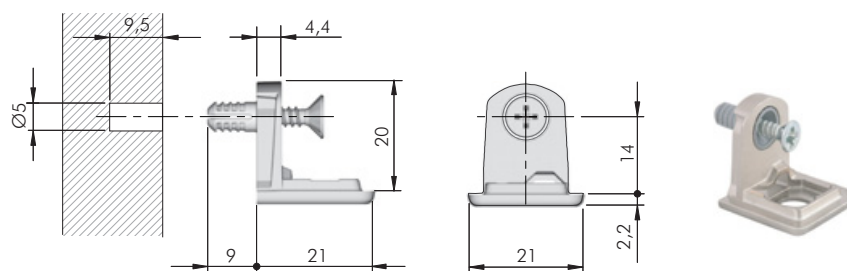

= Ø 5 mm +   
 = PZ2  
 ZA ST EP  = 2000 pcs.

---

11304020YA



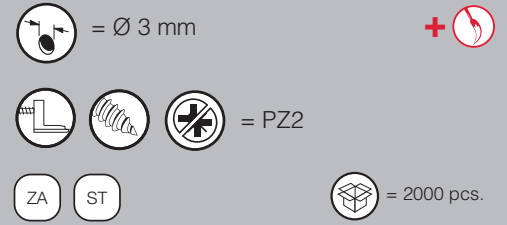
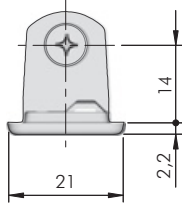
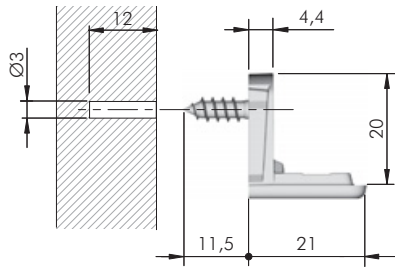
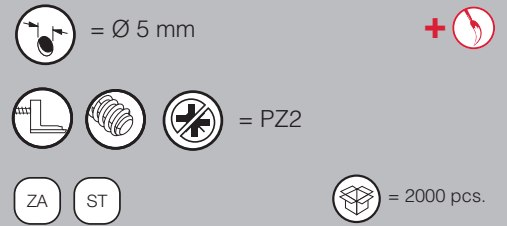
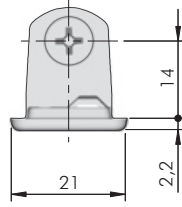
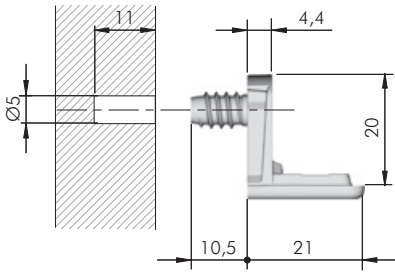

**POKER 30 mm**

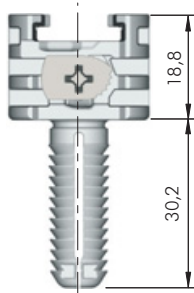
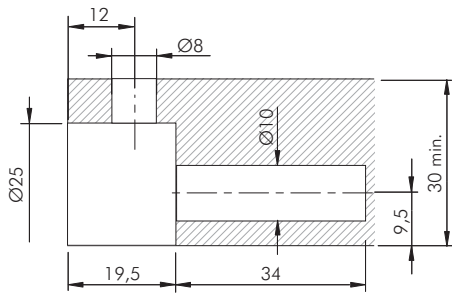

Pre-mounted pin

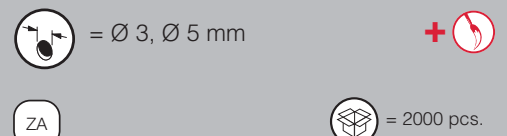
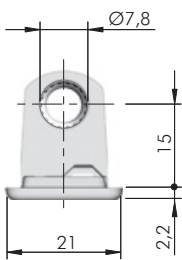
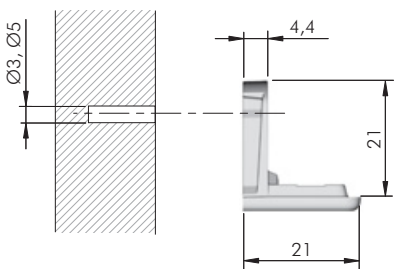
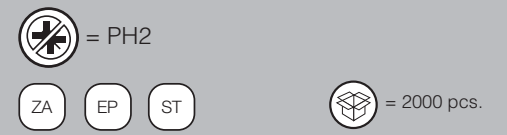
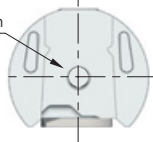

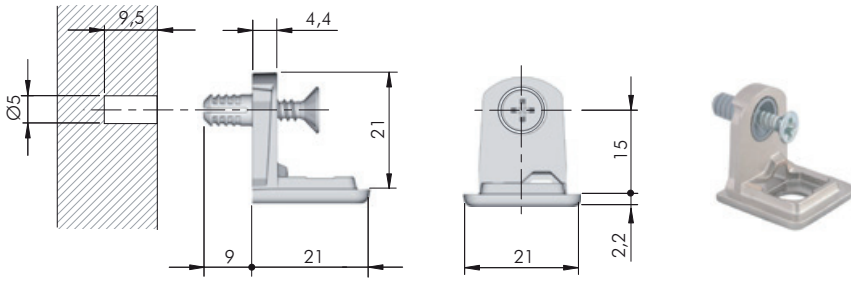

= Ø 5 mm +   
 = PZ2  
 ZA ST EP  = 2000 pcs.

123   
11305020YA

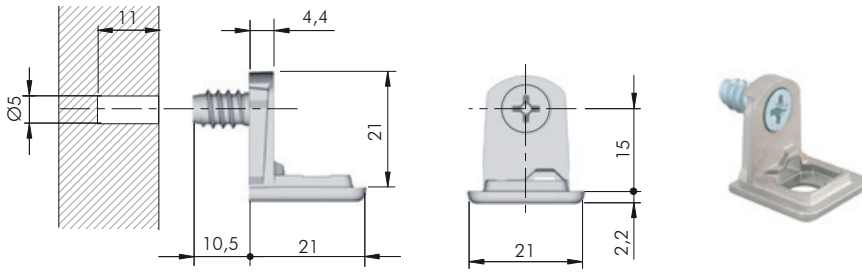

= Ø 5 mm +   
 = PZ2  
 ZA ST  = 2000 pcs.

123   
11305030YA

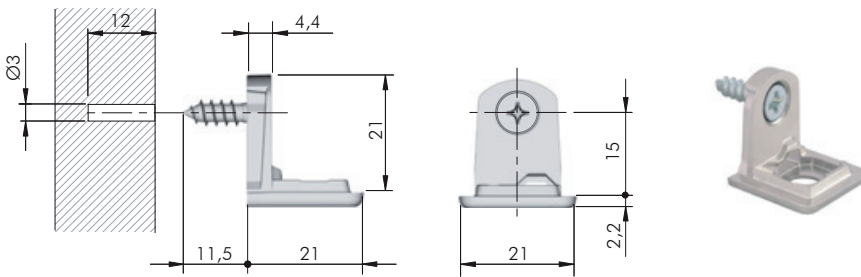

= Ø 3 mm +   
 = PZ2  
 ZA ST  = 2000 pcs.

123   
11305050YA

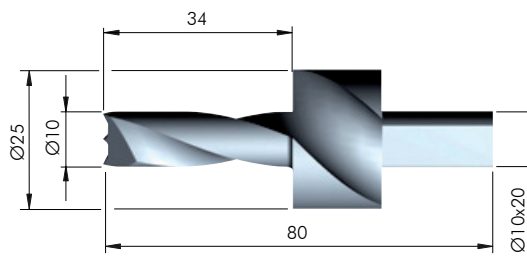
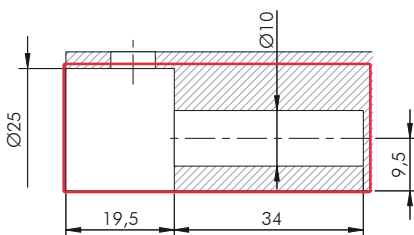

## DRILL BIT FOR POKER 25, 28, 30 mm

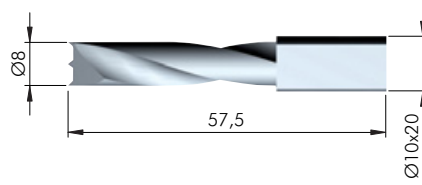
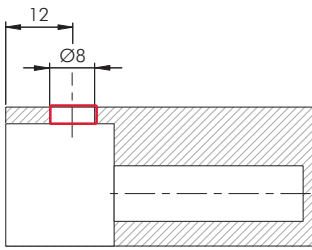

HSS  = on request  
 123   
 1135030000   
 1135040000







HSS  = on request

  |

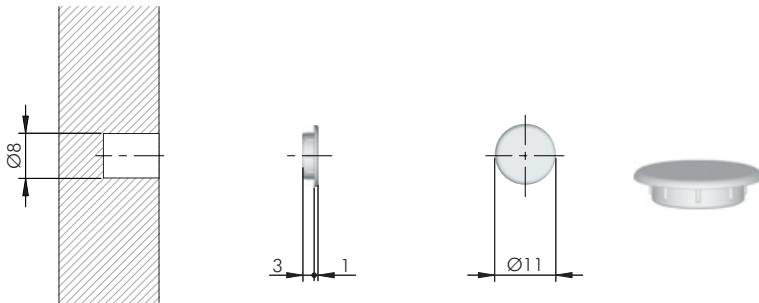

1145202000

**POKER ACCESSORY**



 =  $\varnothing$  8 mm  + 



EP  = 5000 pcs.

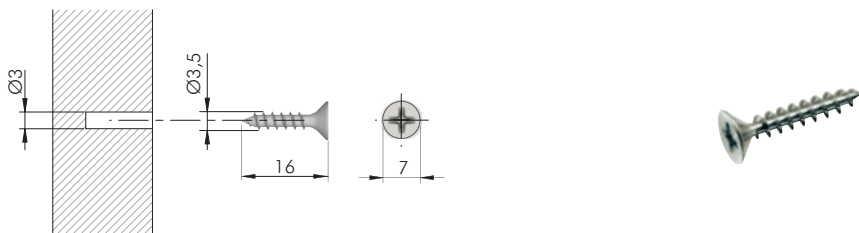

  |

23002010AB



**POKER FIXING ACCESSORIES**



 =  $\varnothing$  3 mm  + 



   = PZ2

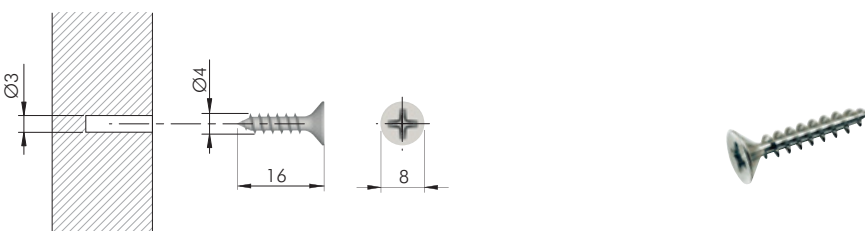

ST  = 10.000 pcs.

  |



60101390ZN



 =  $\varnothing$  3 mm  + 

   = PZ2

ST  = 5000 pcs.

  |

60101570ZN

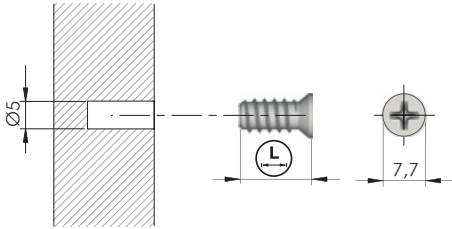

= Ø 5 mm

= PZ2

ST

60502010ZN	10	9000
60501050YA	12,7	5000
60502020ZN	13	5000

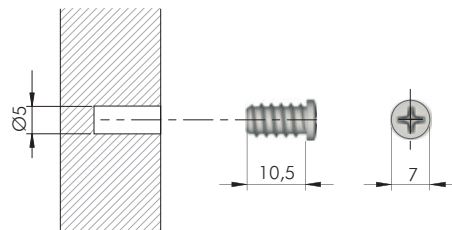

= Ø 5 mm

= PZ2

ST

= 5000 pcs.

60507010YA

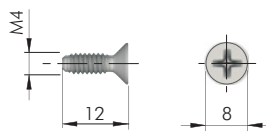

= M4 = PZ2

ST

= 2000 pcs.

60305040ZN

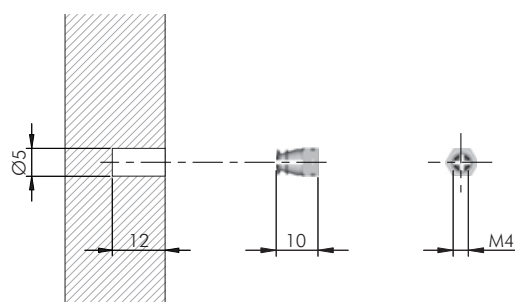



= Ø 5 mm = M4

BR

= 20.000 pcs.

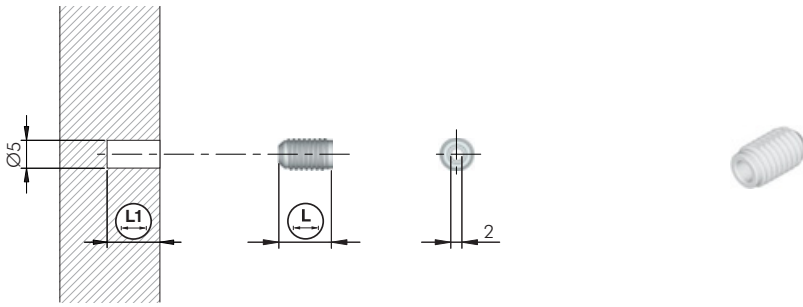
20502021HL



 = Ø 5 mm

EPn

 = 5000 pcs.



20302020AA

9,5

11,5

20302030AA

13

15

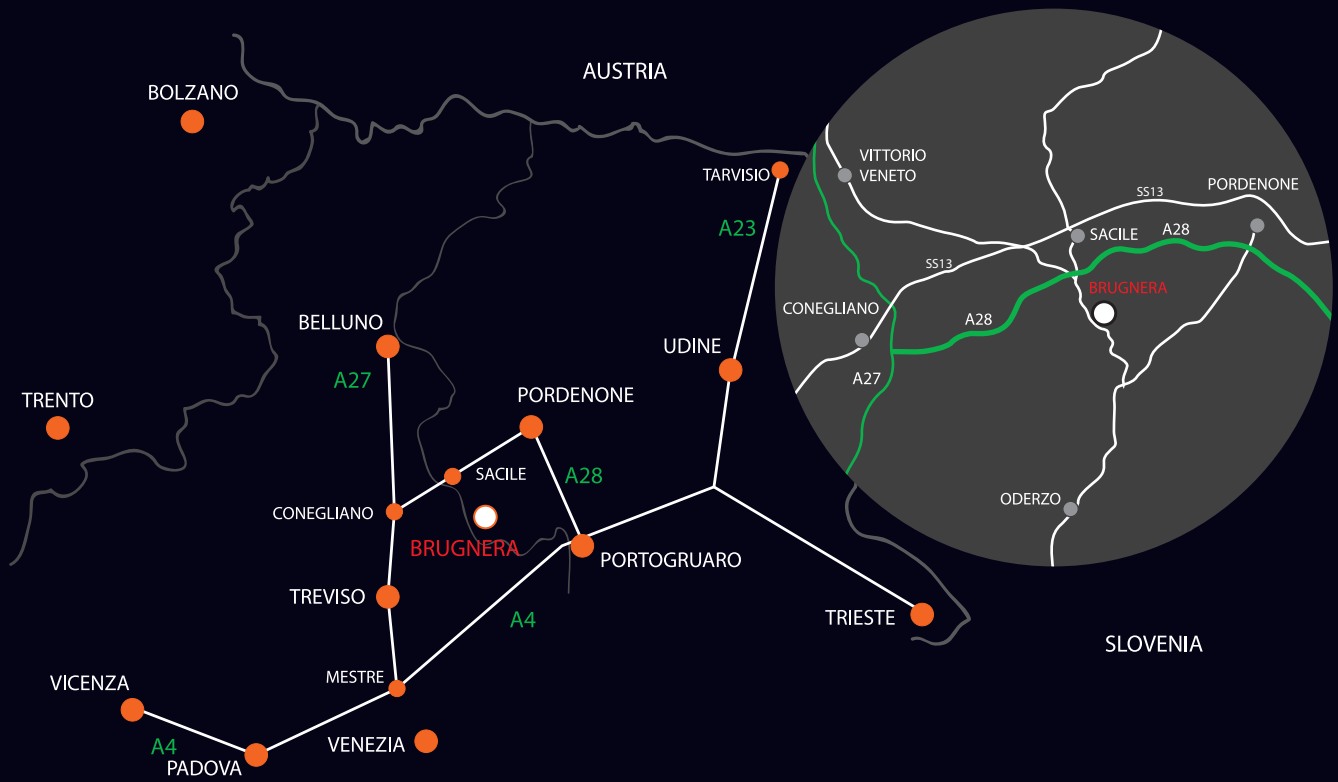

[www.italianaferramenta.com](http://www.italianaferramenta.com)