

Shape and size of Slides based on side of cupboard.

	A	B	C
Slide completely recessed	B+23 mm	Door thickness +0.5 mm	11,5
Slide partially recessed	B+23 mm	Door thickness +0.5 mm	22,5
Slide visible	B+23 mm	Door thickness +0.5 mm	38

POSITION OF Slides

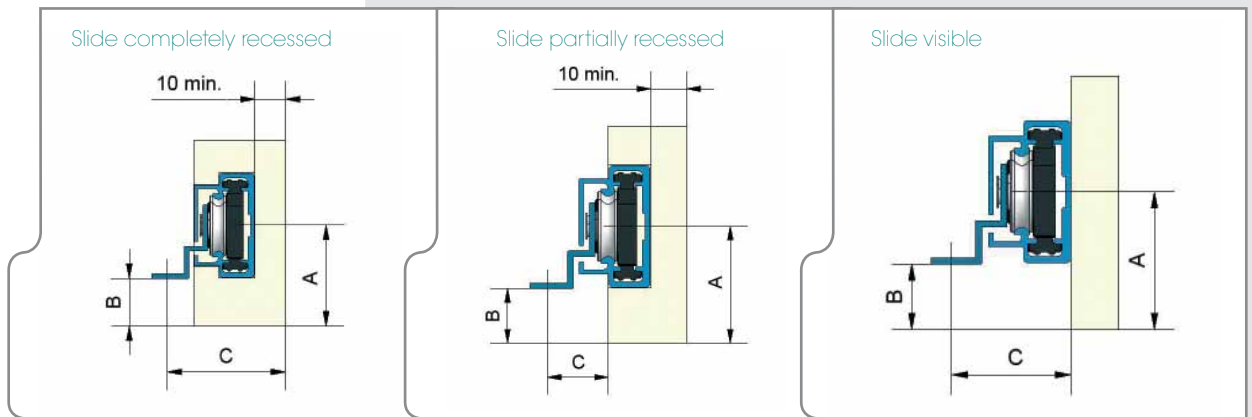

POSITION OF DOORS

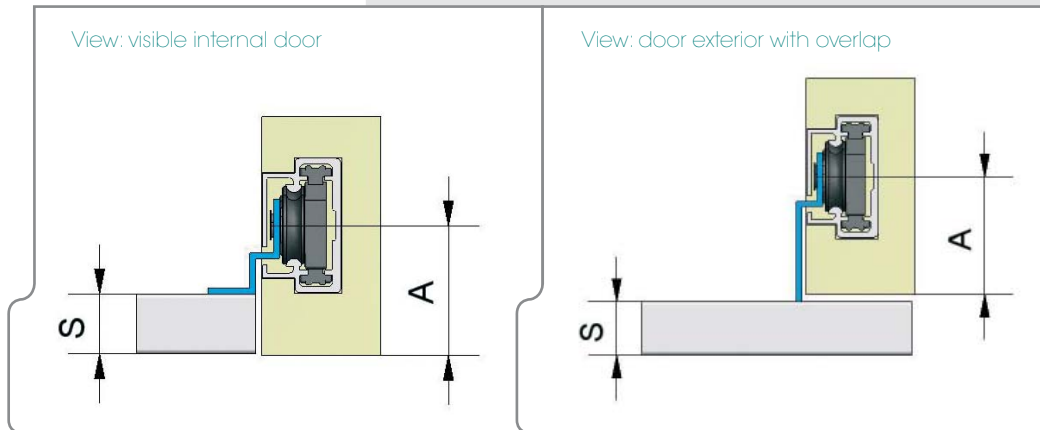

ASSEMBLY

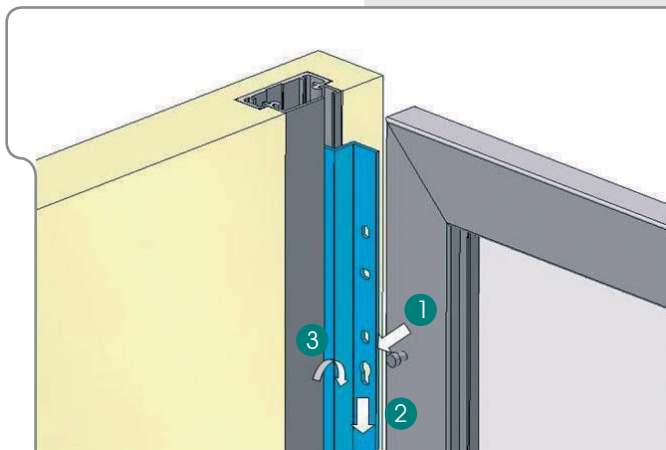

Insert the two Slides into the grooves in the side panels of the cupboard. Once the cupboard structure is assembled attach the door to the bracket by screwing the screws into the slots **1** and fitting the door **2** onto them. Check that the doors are parallel and, once in the correct position, tighten the screws **3**. For greater stability of the door additional holes may be made in the bracket.